

MOE RAIL PRECINCT REVITALISATION PROJECT DESIGN

Public Launch Presentation

07th June 2011



1. Urban Design
2. Civic Centre Building
3. Landscape
4. ESD

1. Urban Design

VISION STATEMENT

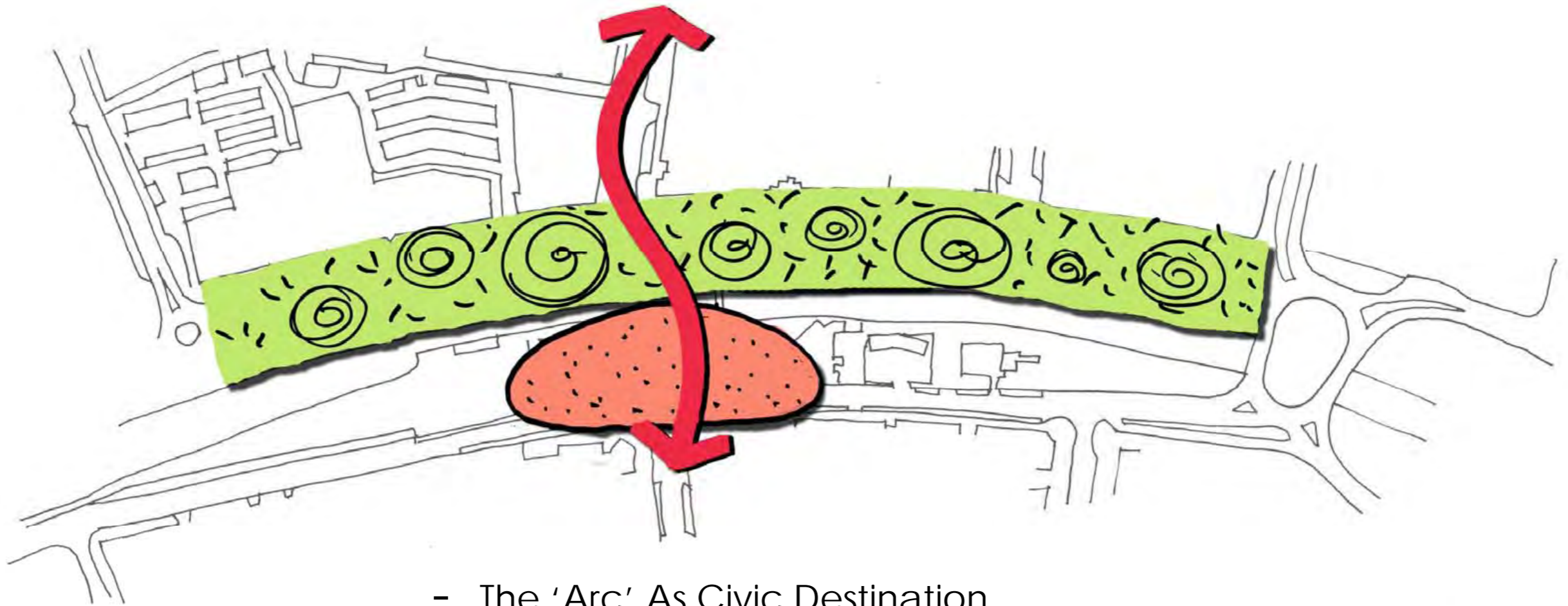

- The 'Arc' As Civic Destination
- "The New Civic"
- Integrated Urban Park – Play & Participate
- Catalyst For Investment + Community Pride
- Transit Destination
- Managed And Curated Hub

CIVIC



urban square



outdoor reading



artwork play



lighting

alfresco cafe

performance



arrival



PLAY



stage music



picnic bbq



seats

active play



play

half court

bouldering



PARK



INTEGRATED ACTIVITIES

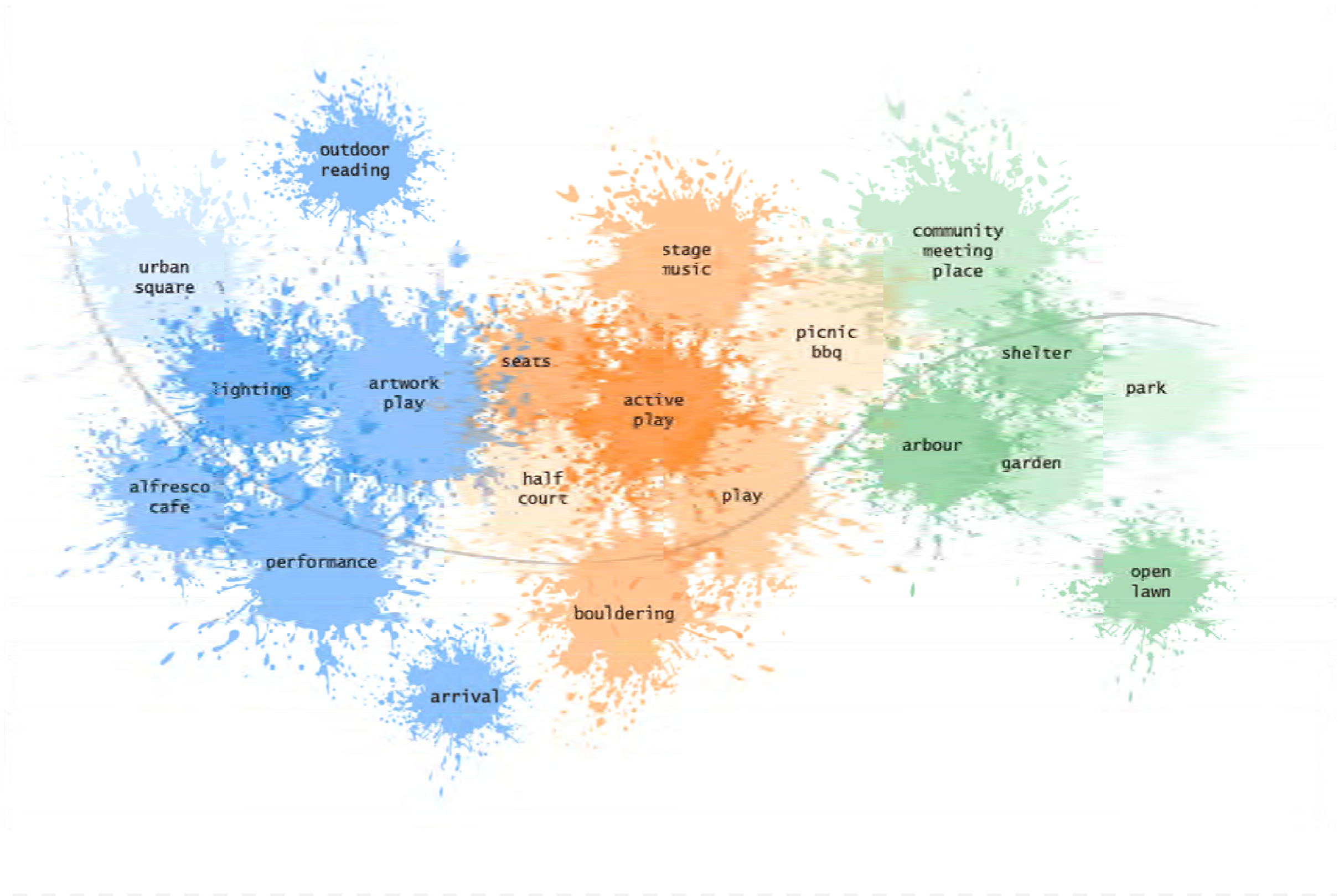

2. Civic Centre Building

APPROACH

PROPOSED STRATEGY

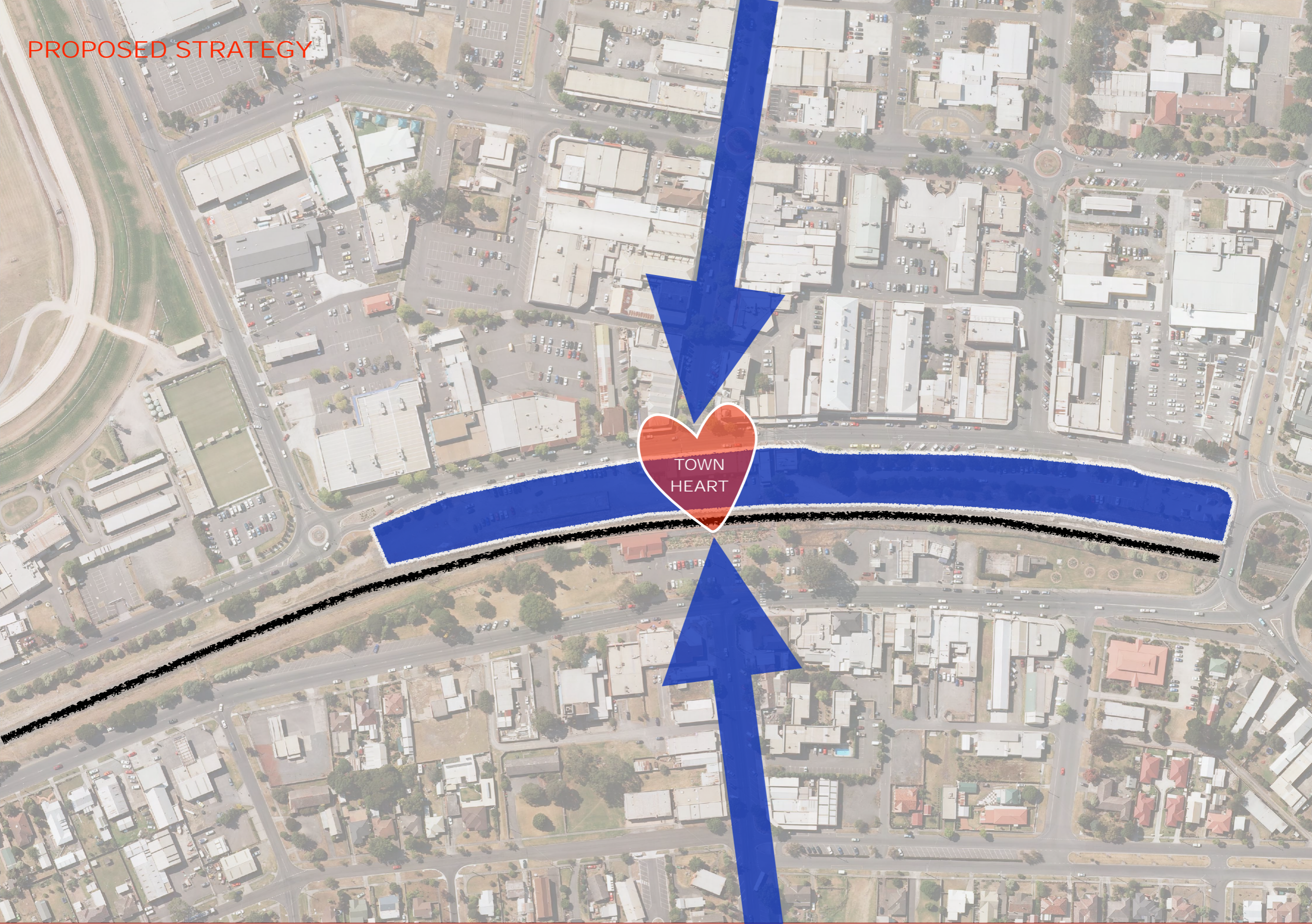

TOWN
HEART

LINEAR ACTIVATION



PLACE

SITE

MOORE ST

GEORGE ST

SITE

PEDESTRIAN CONNECTION

STATION

PROPOSED PLAZA

WINTER SUN

PEDESTRIAN
CONNECTION

PLAZA

PLAZA

SHELTER TO PLAZA

PLANS

GROUND FLOOR PLAN

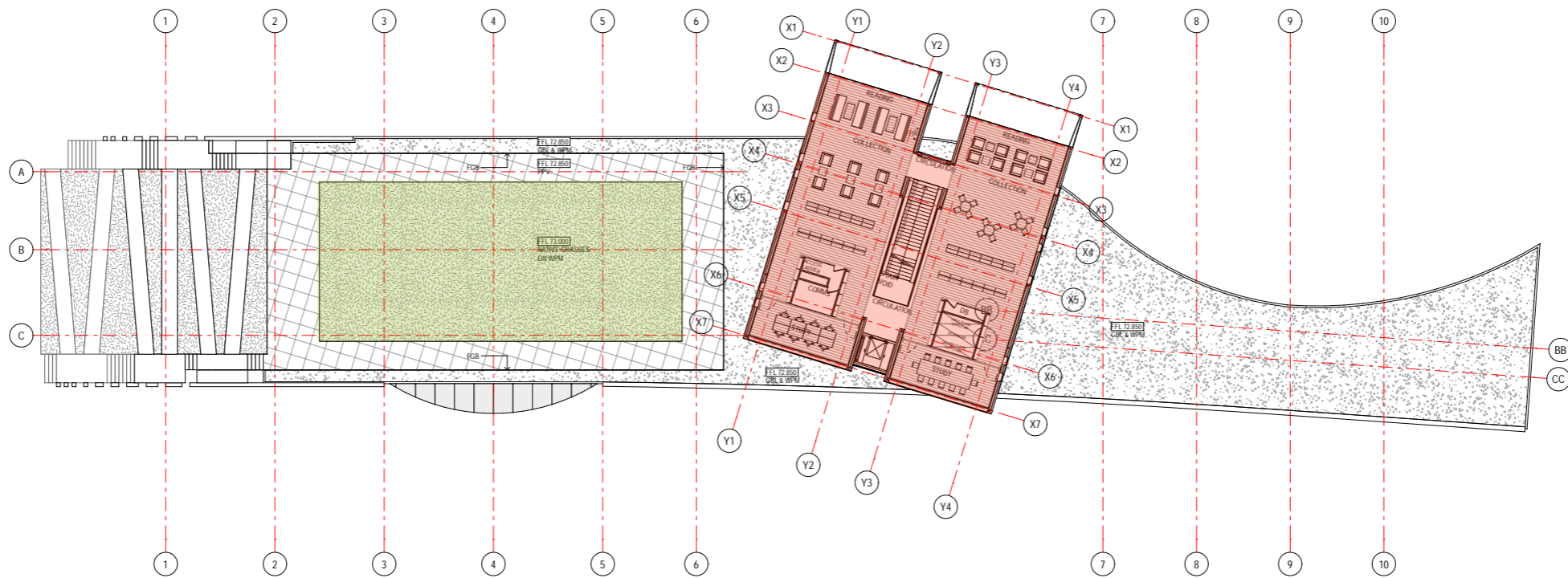

2 PLAN FIRST FLOOR
1:200

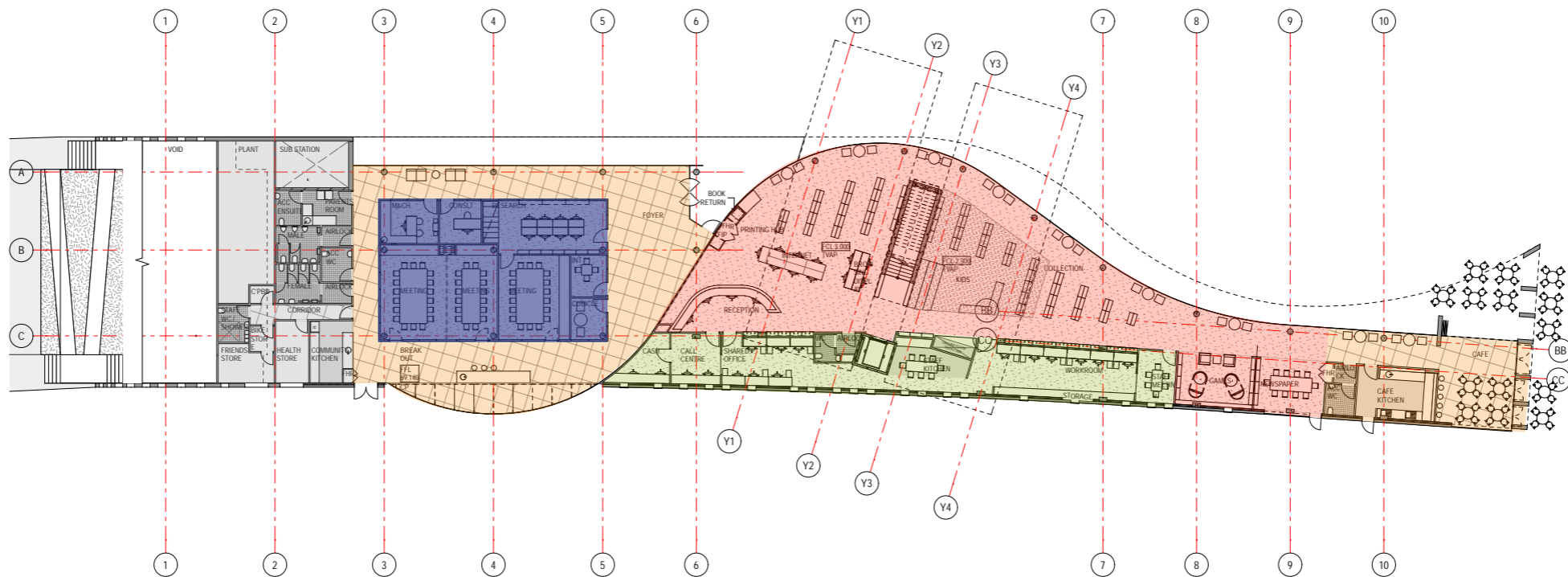

1 PLAN GROUND FLOOR
1:200

LEGEND

CODE	DESCRIPTION
ACT	Acoustic Ceiling Tile
CA	Carpet
CP	Concrete Paver
CS	Concrete Sealed
CT	Ceramic Tile
GBL	Gravel Ballast
LV1	Louvre, Select
LV2	Louvre, Select
OFC	Off Form Concrete, Unpainted AS1100.301
PB	Plasterboard, Paint Finish
PBW	Plasterboard Wet Area Ceiling, Painted
PPV	Precast Pavers
RS	Roof Sheeting
TF	Timber Floor
TB	Timber Batten System
TVAP	Timber Veneer Acoustic Panel
V	Vinyl Veneer Ceiling Panel
WPM	Water Proof Membrane

GENERAL ARRANGEMENT PLANS 01
LaTrobe City Council - MOE RAILWAY PRECINCT

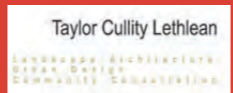
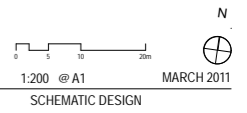

PERSPECTIVES

VIEW LOOKING SOUTH WEST FROM GEORGE ST



VIEW LOOKING SOUTH FROM MOORE ST



VIEW LOOKING SOUTH EAST TOWARDS THE ENTRY



AERIAL VIEW LOOKING SOUTH EAST OVER GREEN ROOF



VIEW LOOKING EAST TOWARDS THE PODIUM RAMP & STAIR



ELEVATED VIEW LOOKING NORTH EAST FROM THE PLATFORM



VIEW LOOKING NORTH FROM THE TRAIN STATION



VIEW LOOKING TOWARDS THE CAFE FROM THE LEVEL RAIL



INTERNAL VIEW OF COMMUNITY MEETING ROOM HUB LOOKING WEST



INTERNAL VIEW OF RECEPTION LOOKING EAST



INTERNAL VIEW FROM STAFF WORKROOM LOOKING NORTH WEST



INTERNAL VIEW FROM LIBRARY COLLECTION LOOKING SOUTH EAST



SECTIONAL VIEW THROUGH LIBRARY COLLECTION LOOKING WEST



INTERNAL VIEW FROM LEVEL 1 LOOKING NORTH TOWARDS MOORE ST

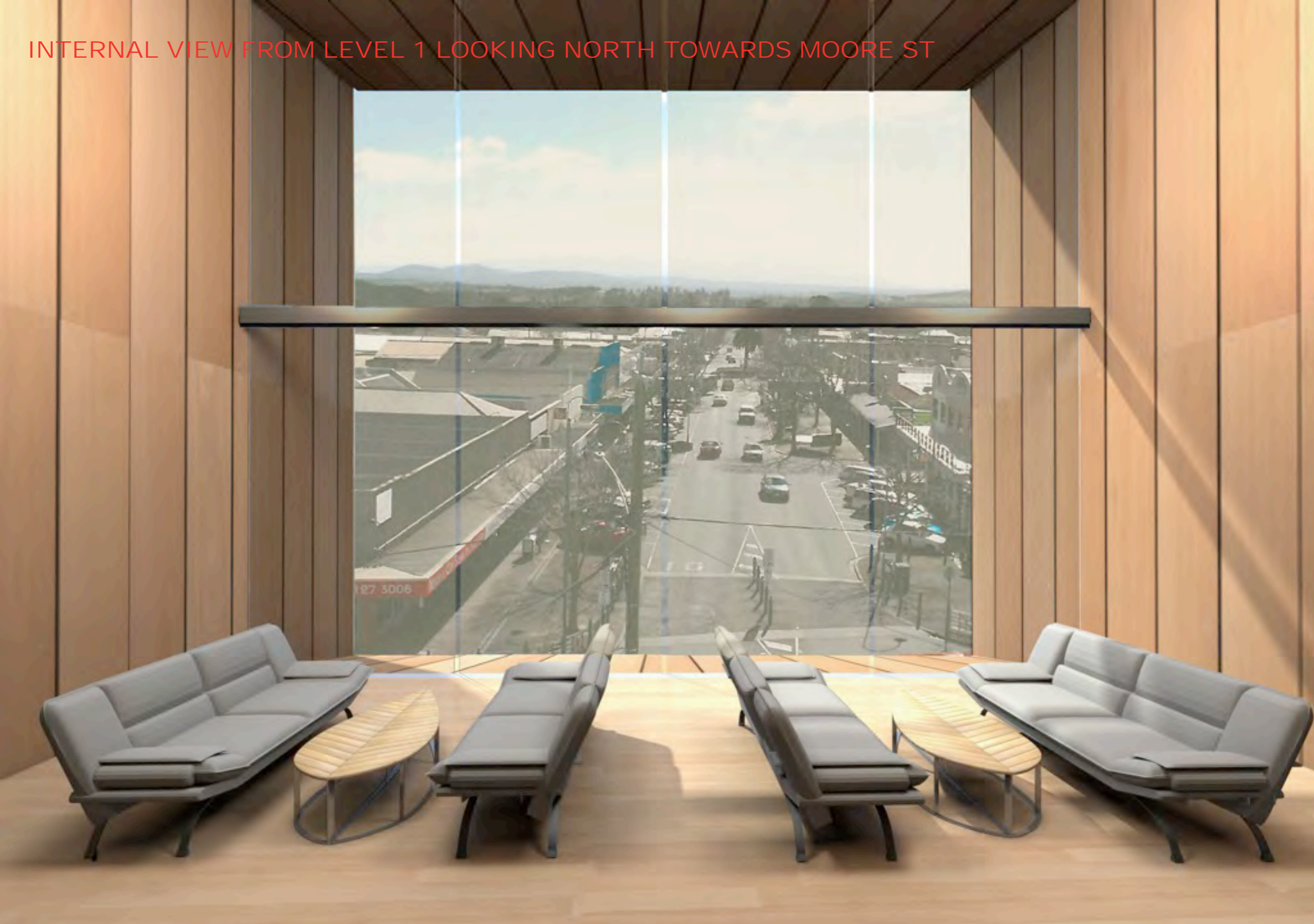

PRECEDENTS

COMMUNITY



CAFE



LIBRARY



3. Landscape

CONCEPT DESIGN

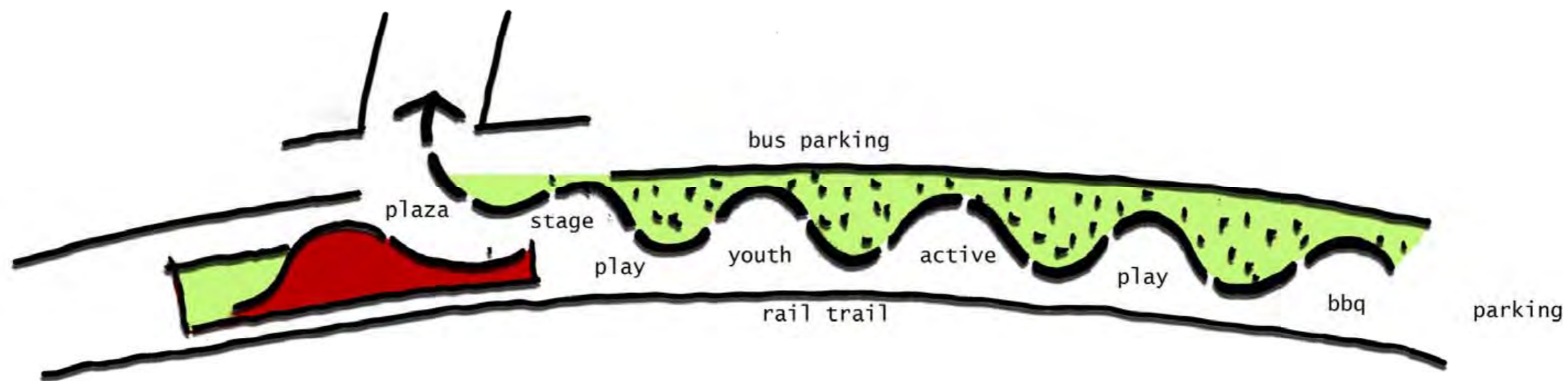

SKETCH DESIGN

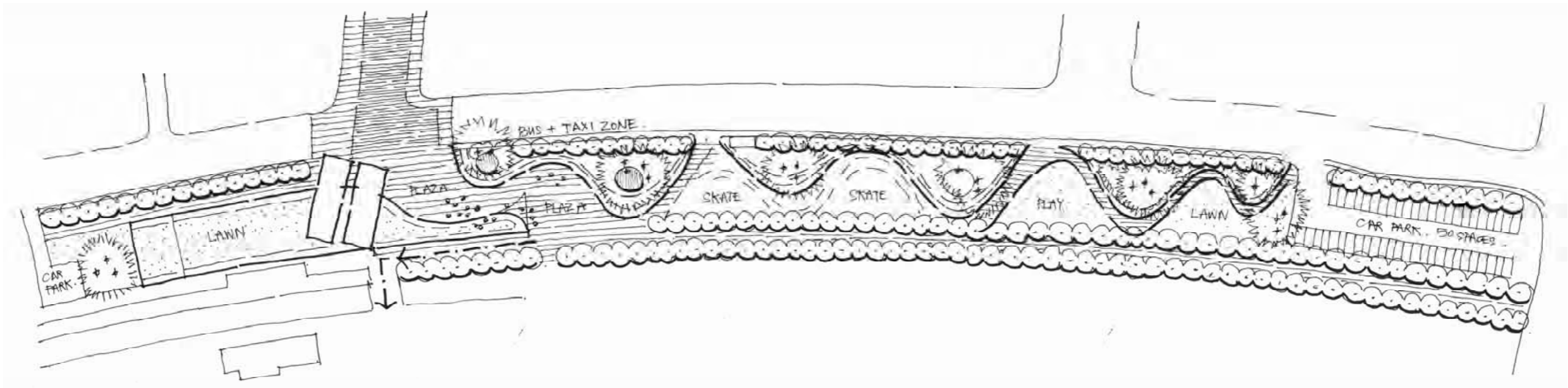

DESIGN DEVELOPMENT



MOORE STREET SHARED ZONE



CIVIC PLAZA

Connecting the Civic Hub and Civic Landscape

Strong connections to Moore St

Creates visual connections to the South

Efficient and safe pedestrian connections between North and South

Public Edges to Civic Plaza

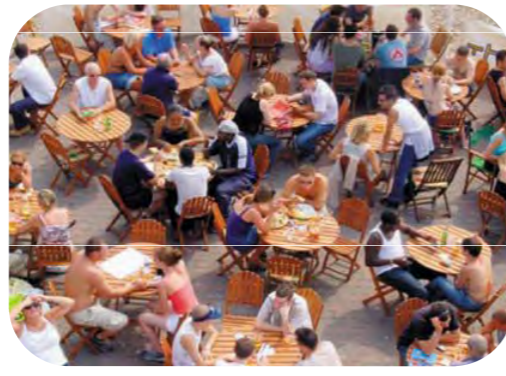

CIVIC PLAZA

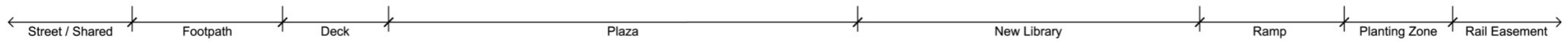

DAY TO DAY CAFE MODE

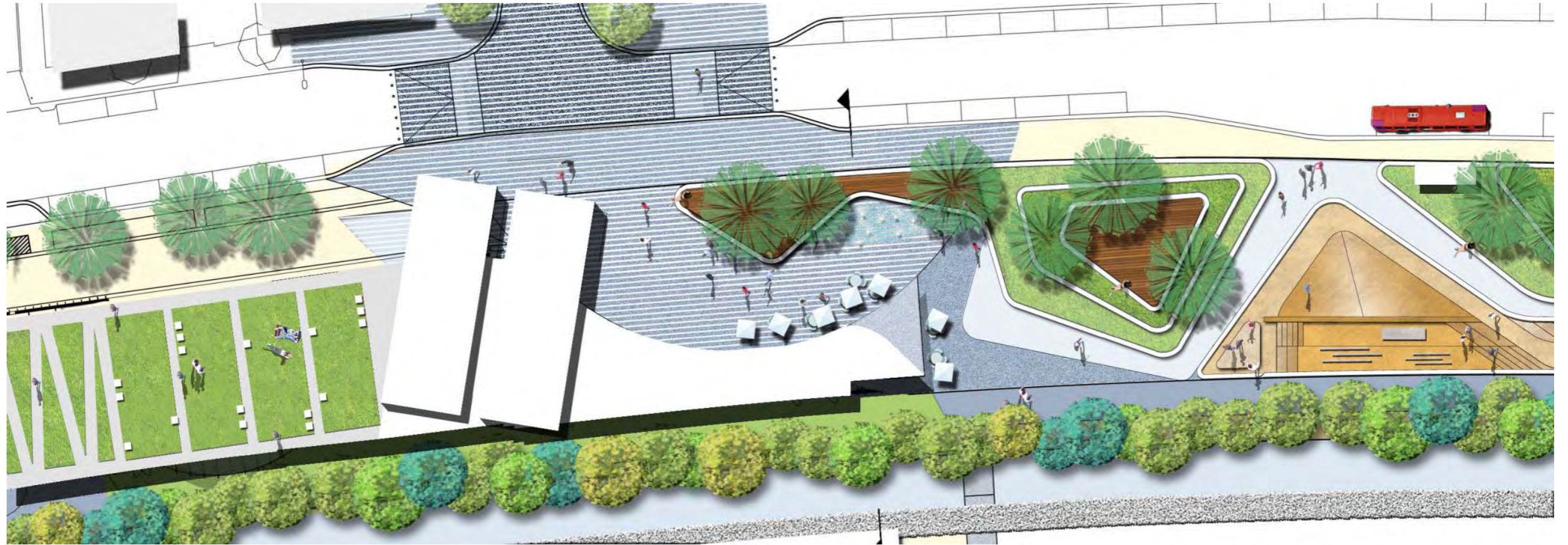

MARKET MODE

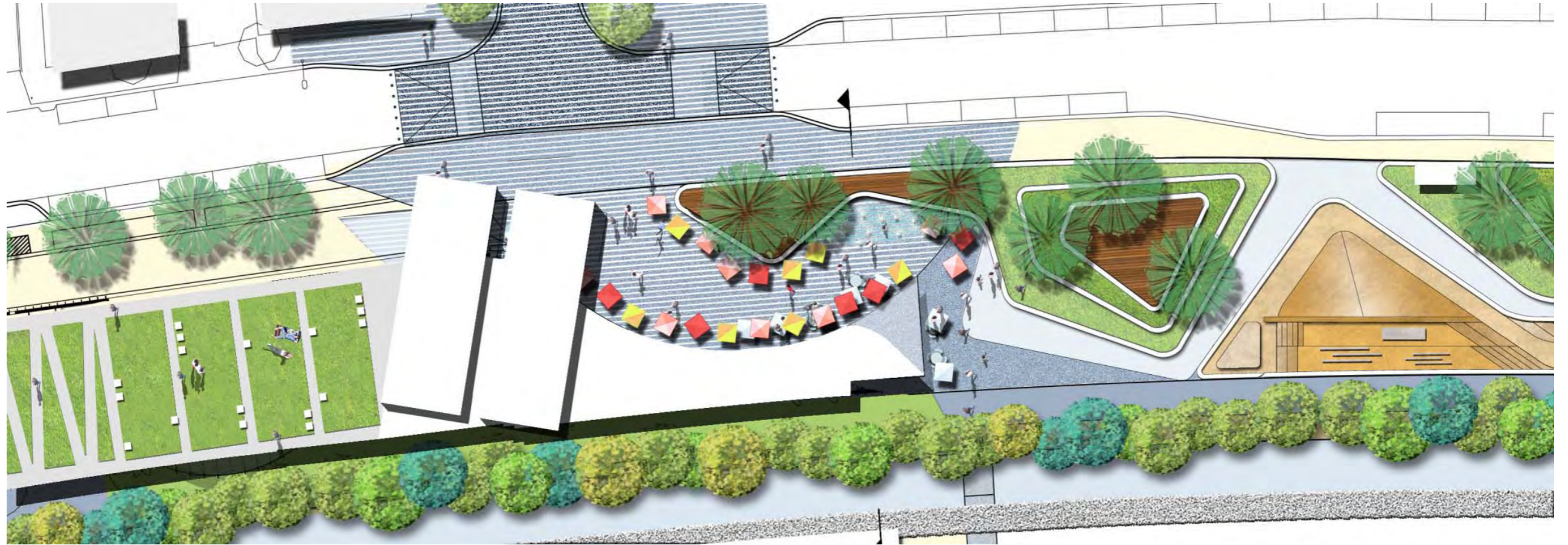

PERFORMANCE MODE

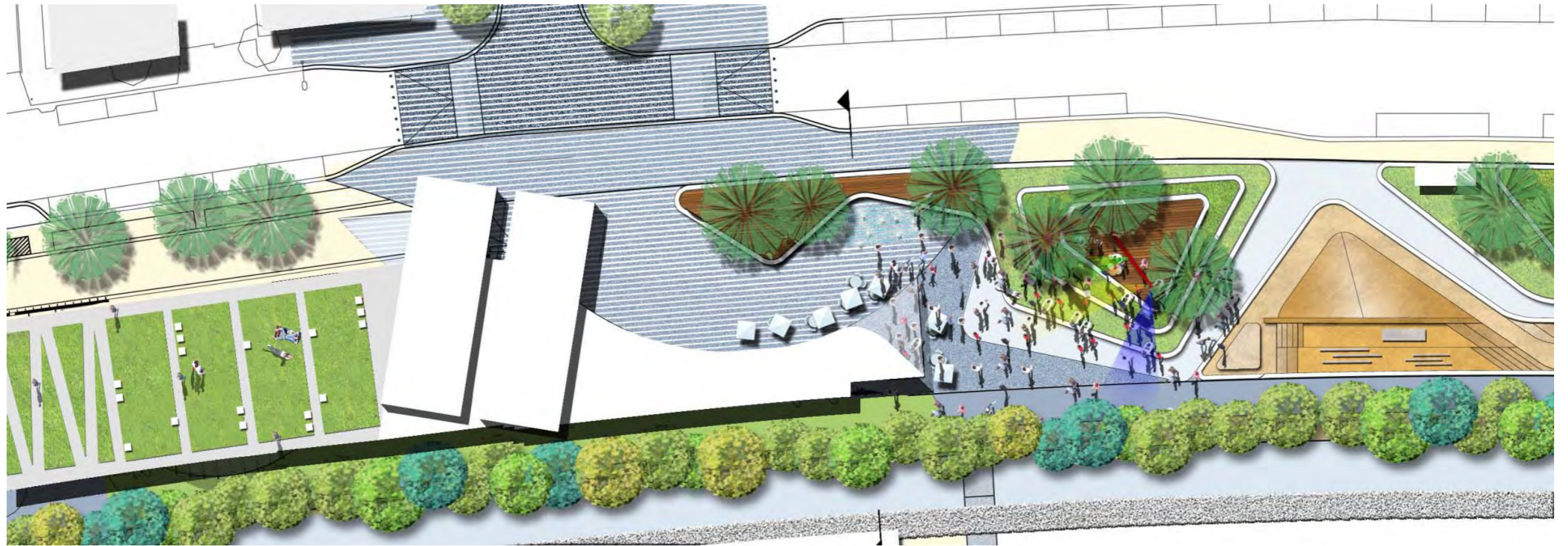

FESTIVAL MODE

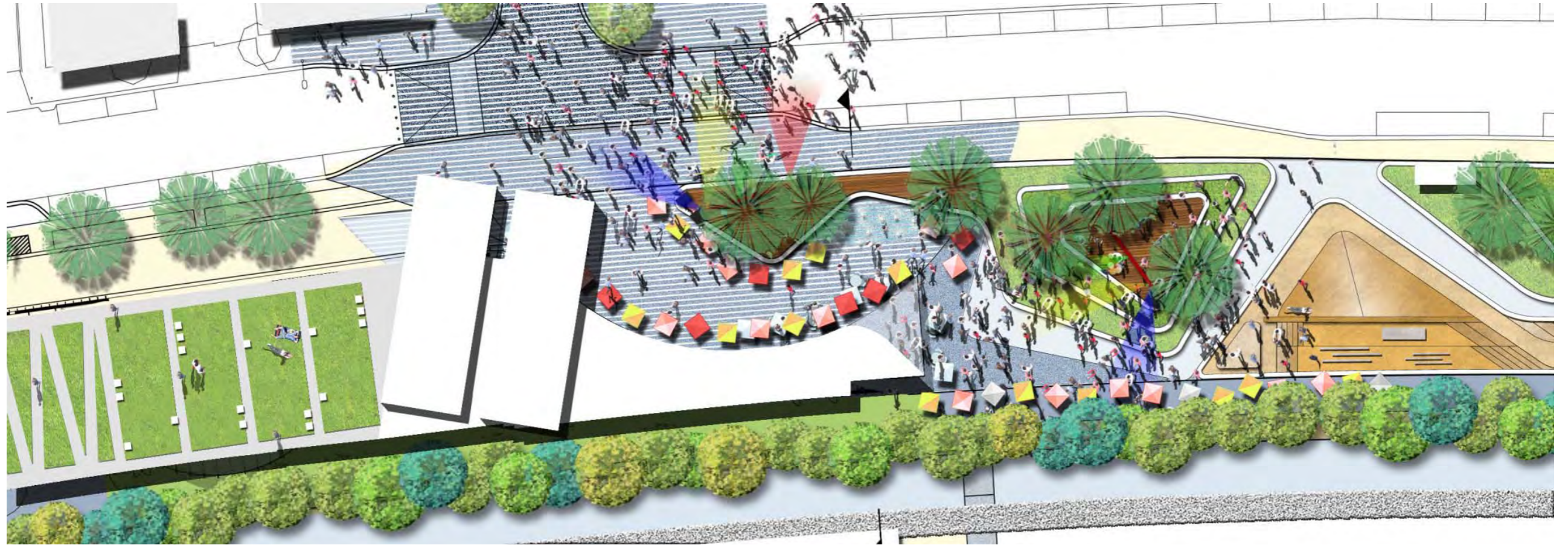

EVENING PERFORMANCES



YOUTH PRECINCT

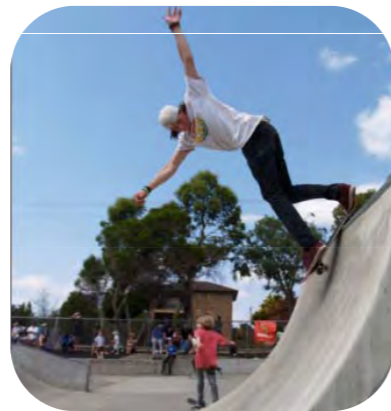

GEELONG YOUTH ACTIVITY AREA



YOUTH PRECINCT

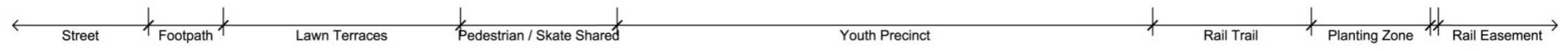

BBO AND PLAYGROUND FACILITIES



SAFE CAR PARKING



THE VISION



4. ESD

Sustainable Design Principles

- 5 Star Green Star Public Building equivalent (Australian Excellence)
- Reduced carbon footprint of 30-40% c/f conventional building of same type
- Significantly reduced energy consumption
- Minimised water consumption
- Improved indoor environment quality

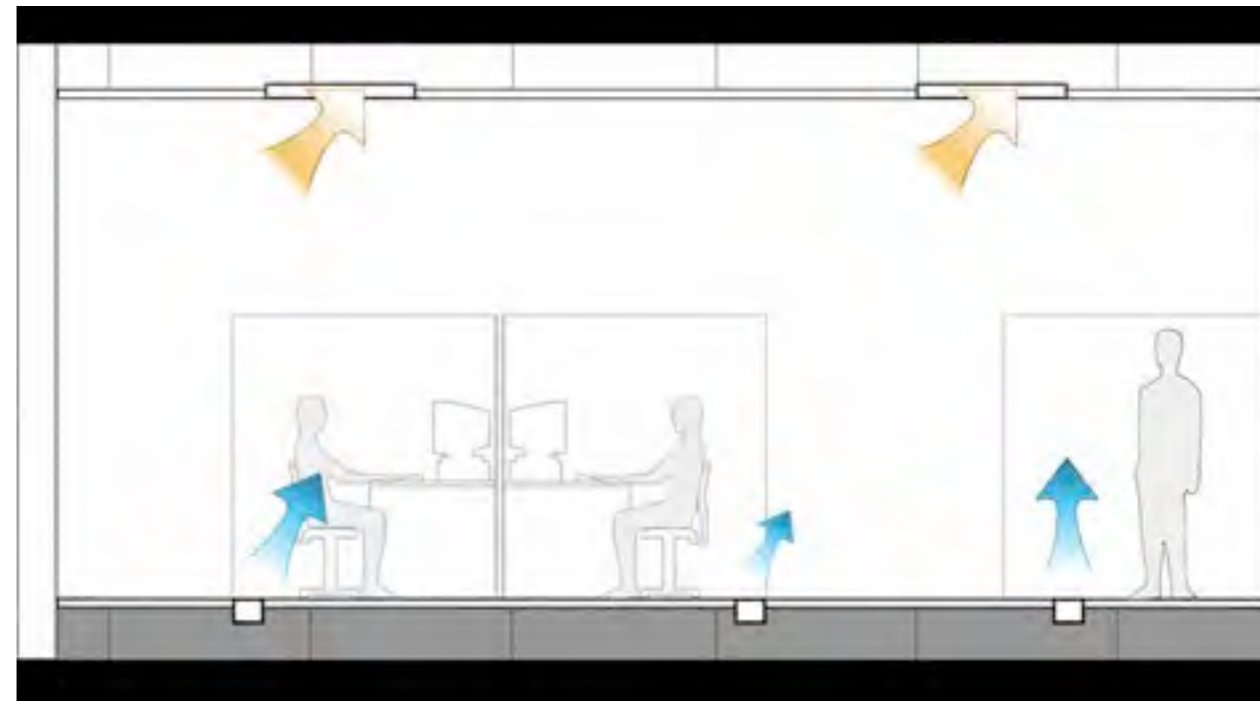

WHAT IS A GREEN ROOF

A green roof is a roof of a building that is partially or completely covered with vegetation and a growing medium, planted over a waterproofing membrane. It may also include additional layers such as a root barrier and drainage and irrigation systems.

Source Wikipedia

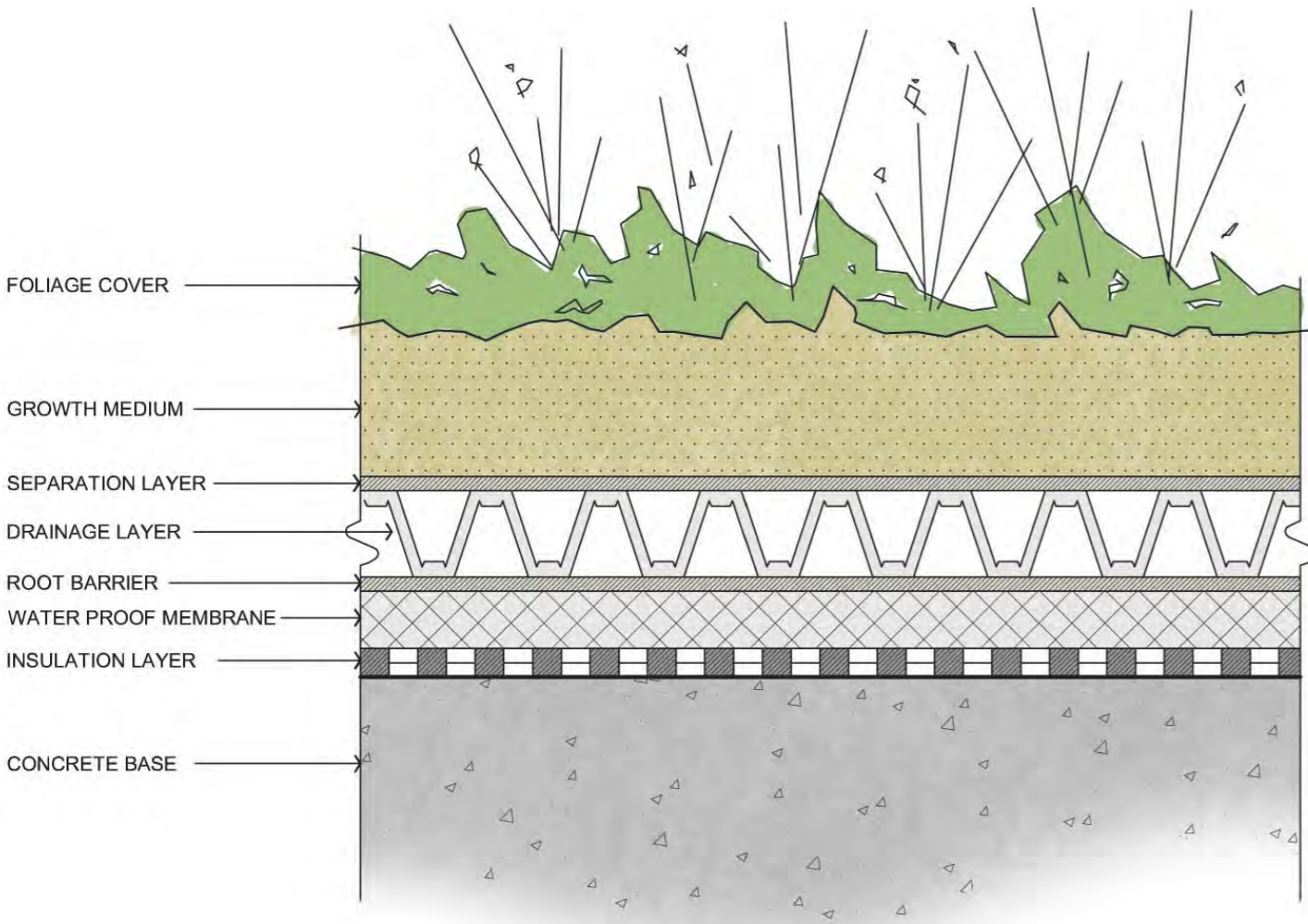

Typical Green Roof Structure



MAFRI Roof Garden: Queenscliff

THANK YOU

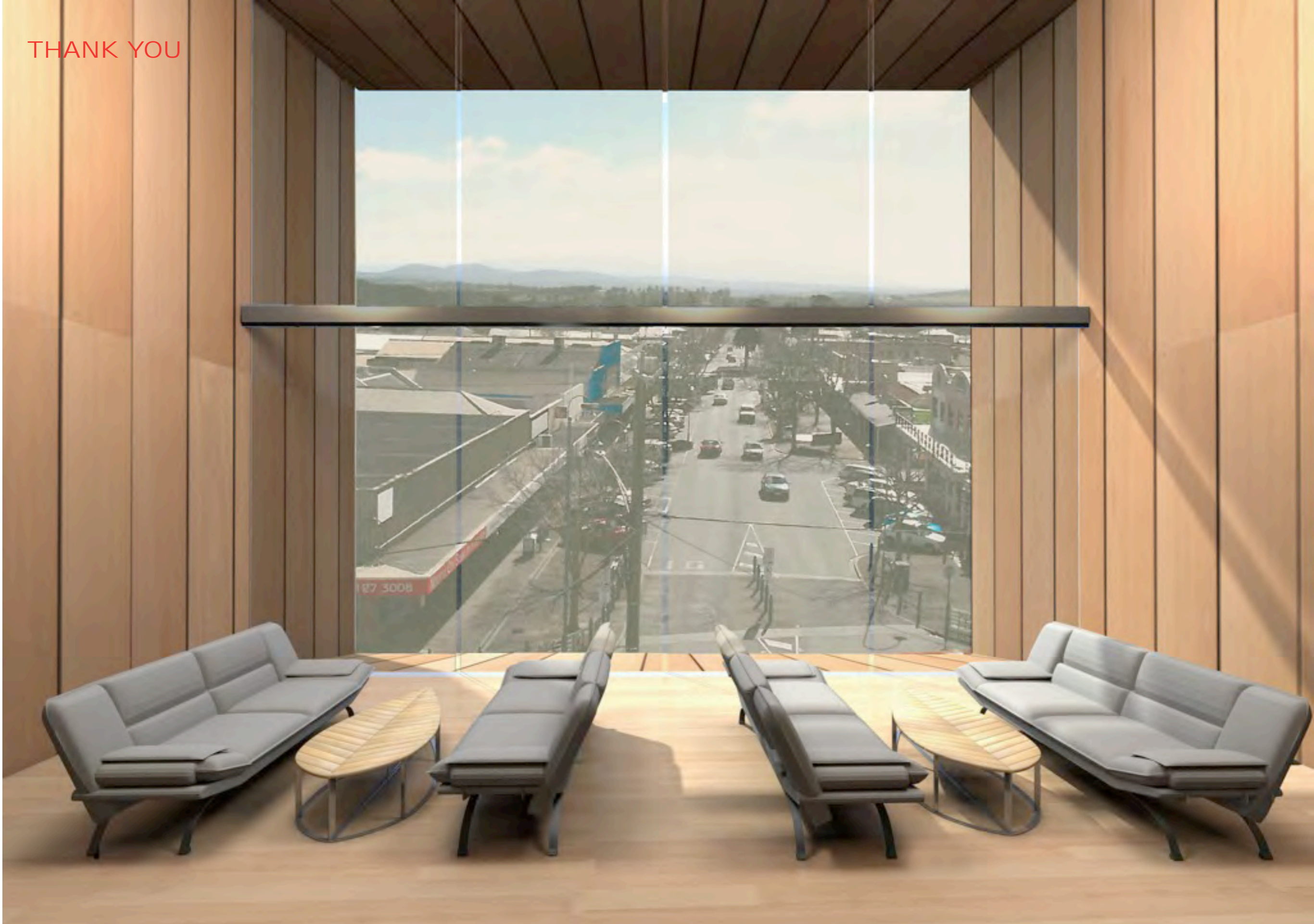

MOE RAIL PRECINCT REVITALISATION PROJECT DESIGN

Public Launch Presentation

07th June 2011



Urban Design

EXISTING CONDITIONS



- road
- car park/ access
- railway
- public park and recreation
- skate
- vacant land
- built form
- trees

CIRCULATION

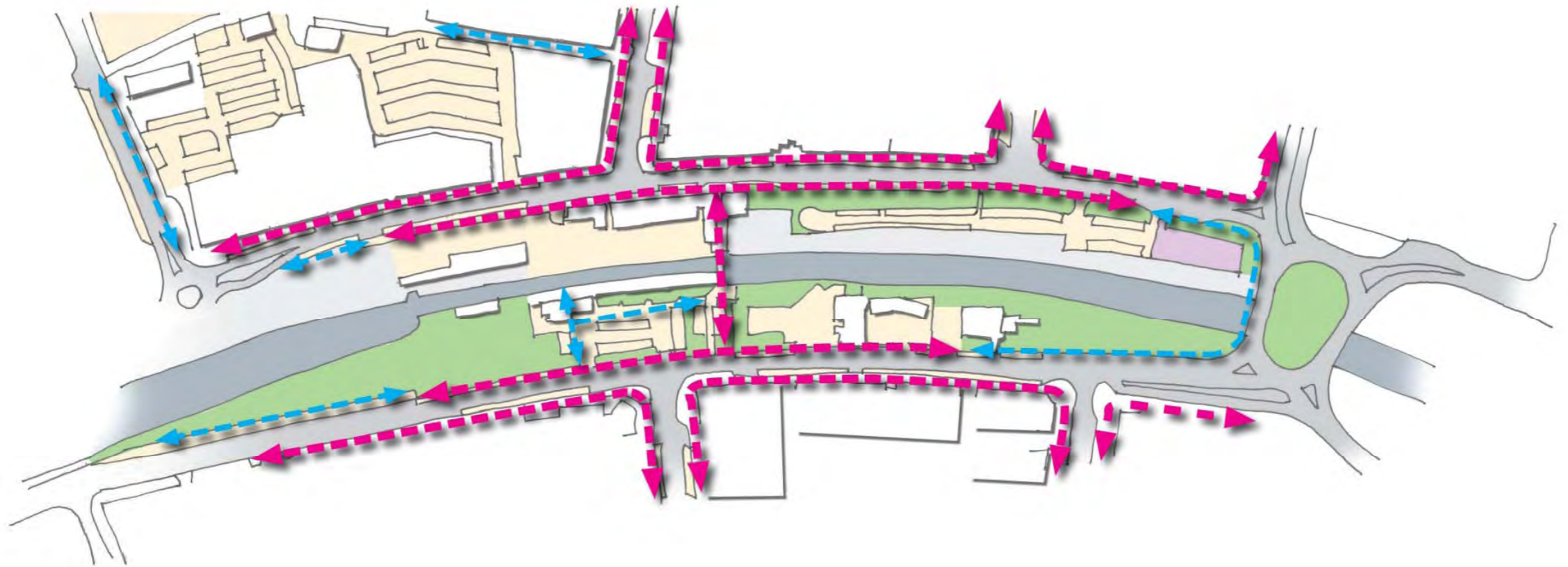

VISUAL CONNECTIONS

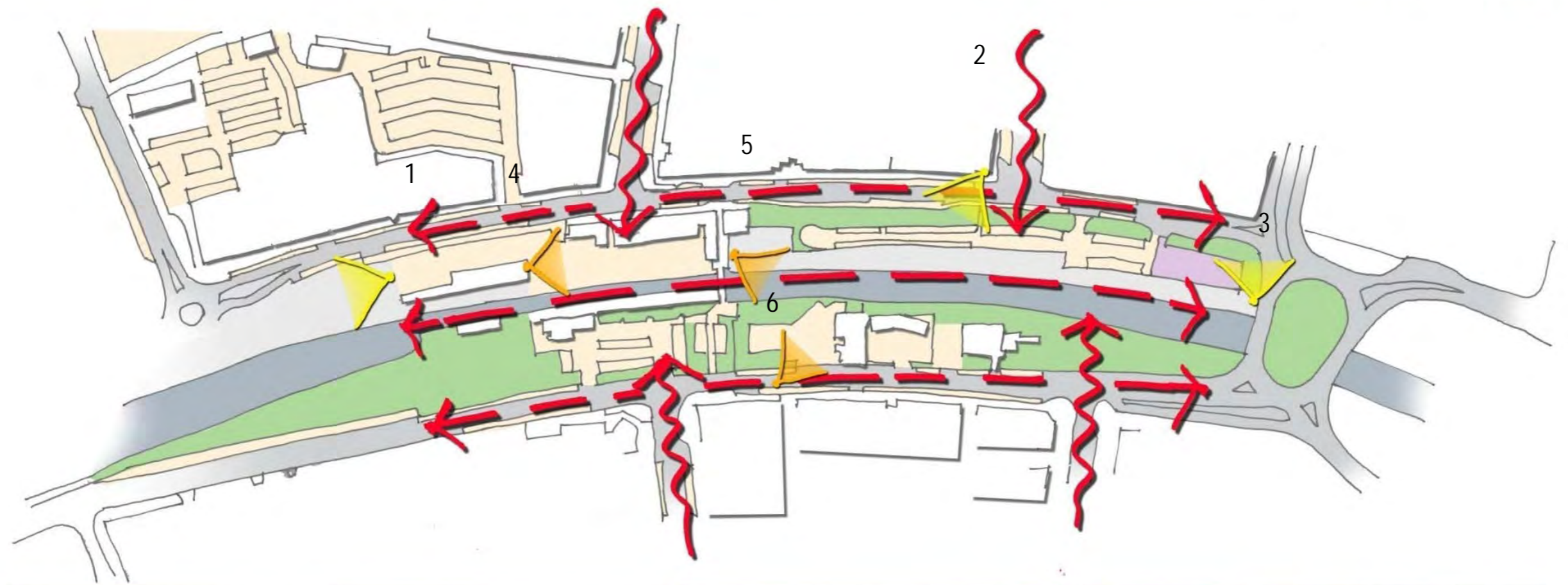

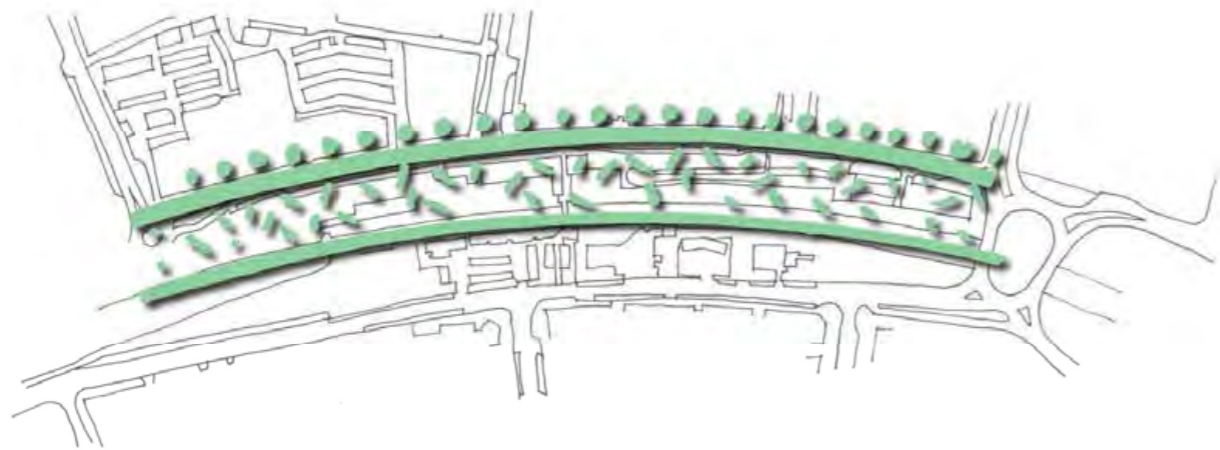

The Arc as Civic Destination



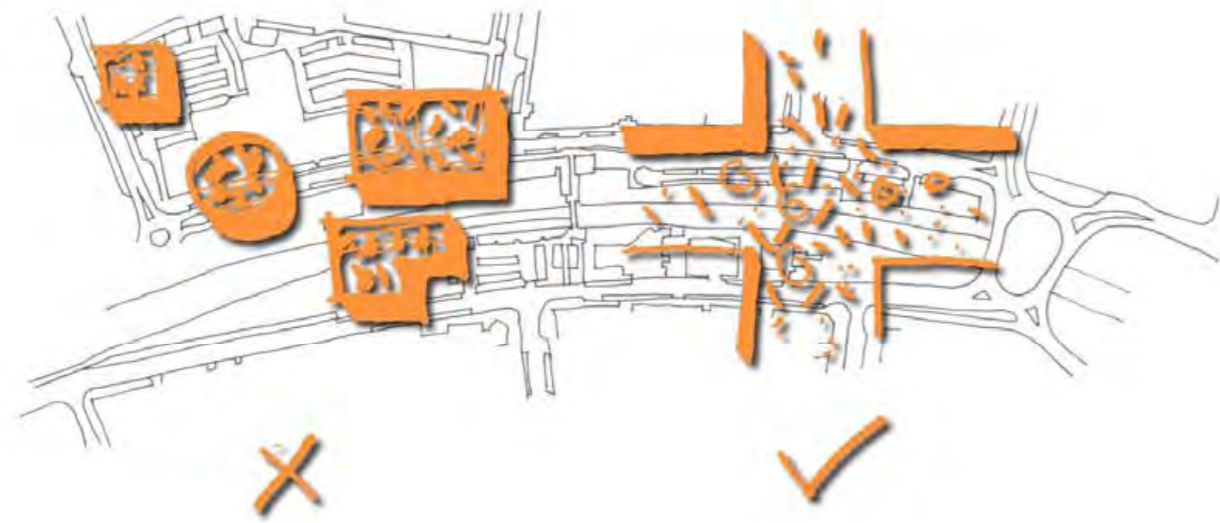

The New Civic



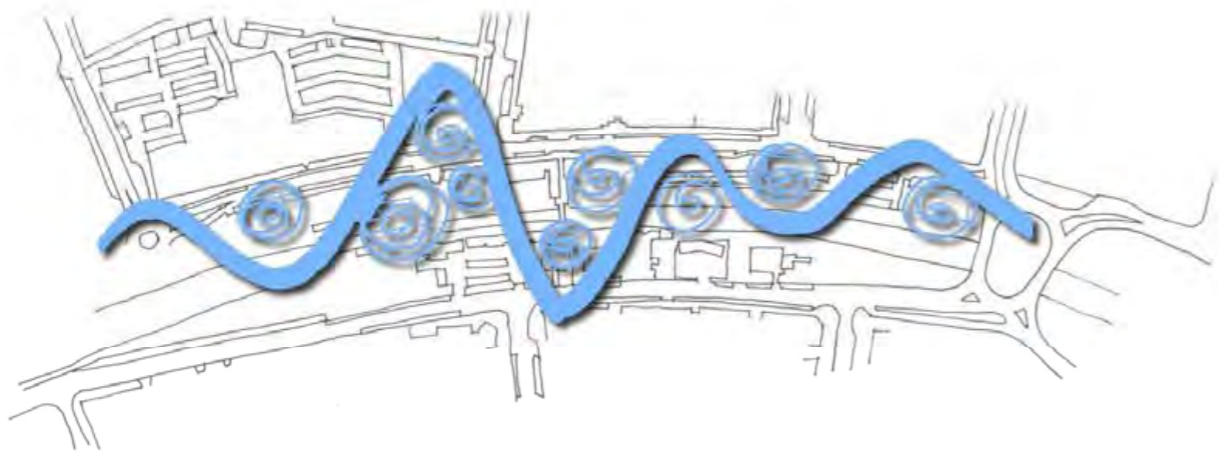

Integrated Urban Park.
Learn, Play and Participate.

We don't stop playing
Because we grow old
We grow old
Because we stop playing





A Catalyst for Investment
+
Community Pride.



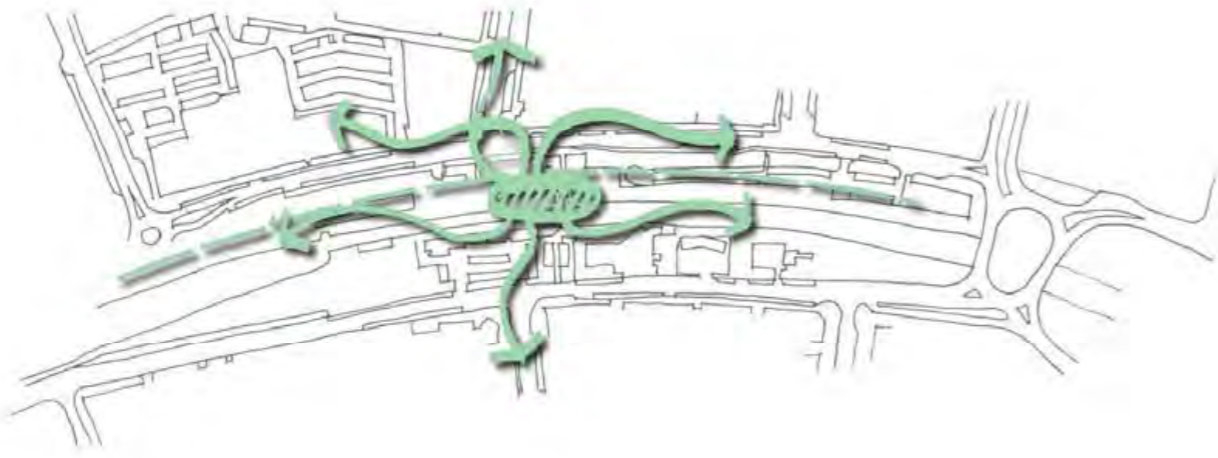

Transit Destination



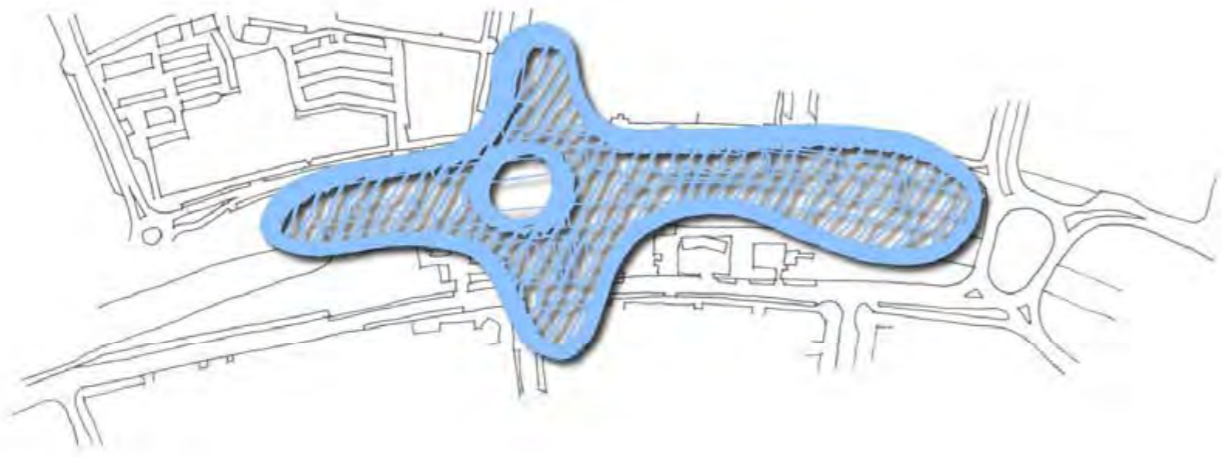

A Managed and Curated Hub.



Civic Centre buiding

ORIENTATION / VIEWS

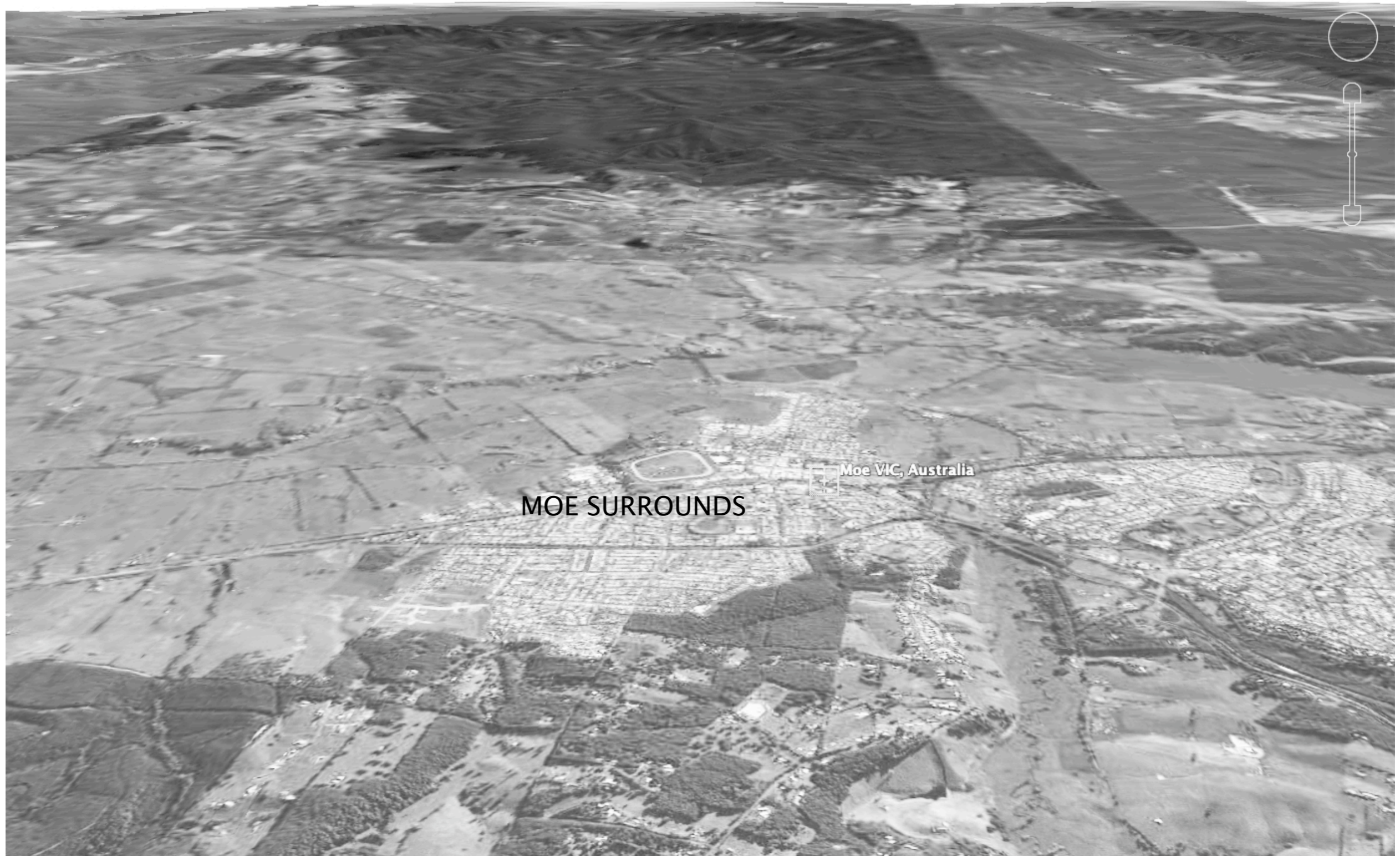

Views: Highest Points

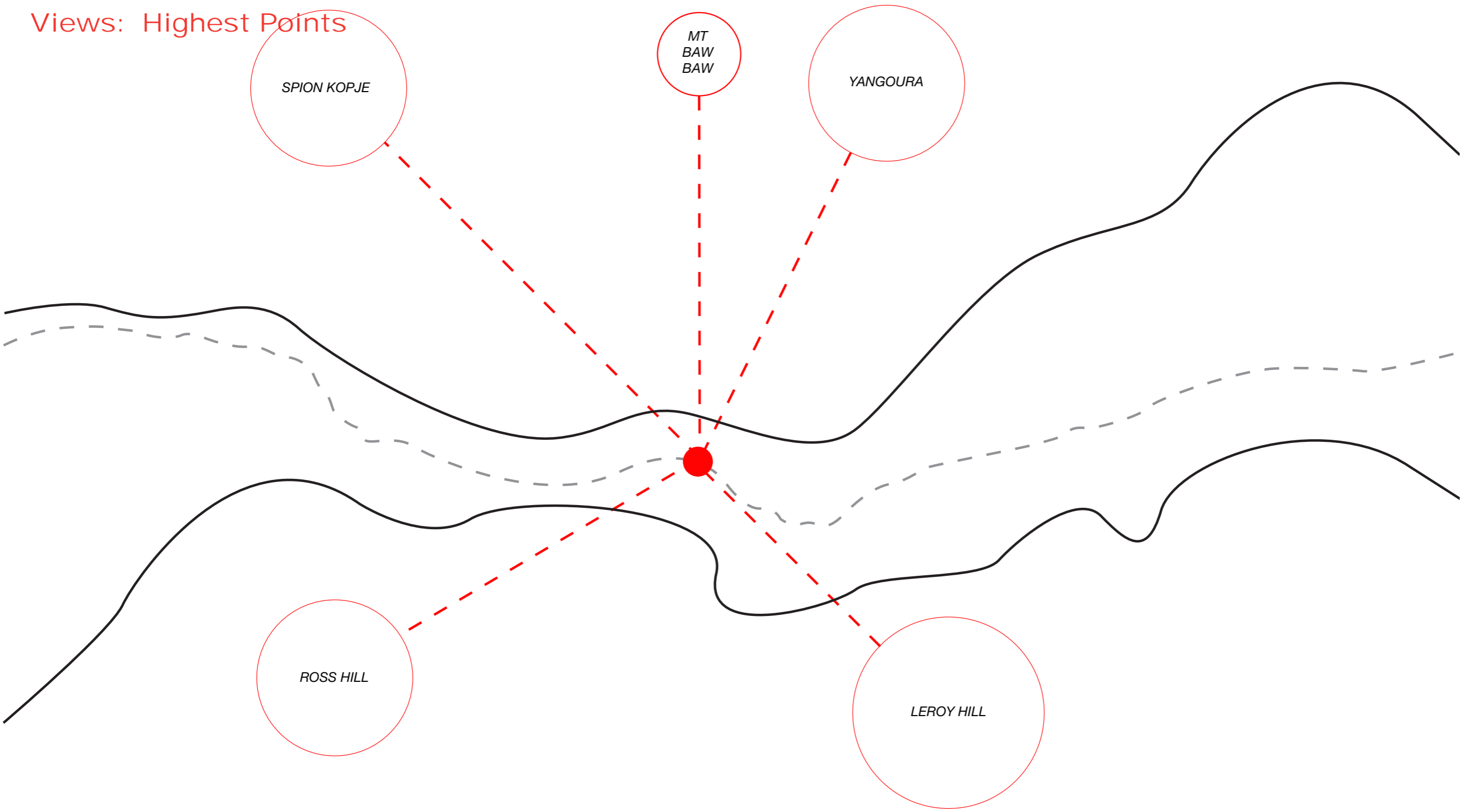

HEIGHT: 12m

WEST

NORTH

EAST

SOUTH

WEST

MOORE ST

MT BAW BAW

FOWLER ST

ROSS HILL

STREZELECKI RANGES



HEIGHT: 6m

WEST

NORTH

EAST

SOUTH

WEST

MT BAW BAW

ROSS HILL

STREZELECKI RANGES



MOORE ST

FOWLER ST

Mt Baw Baw



Strezelecki Ranges



POINT ACTIVATION



ACTIVITY RELATIONSHIP DIAGRAM

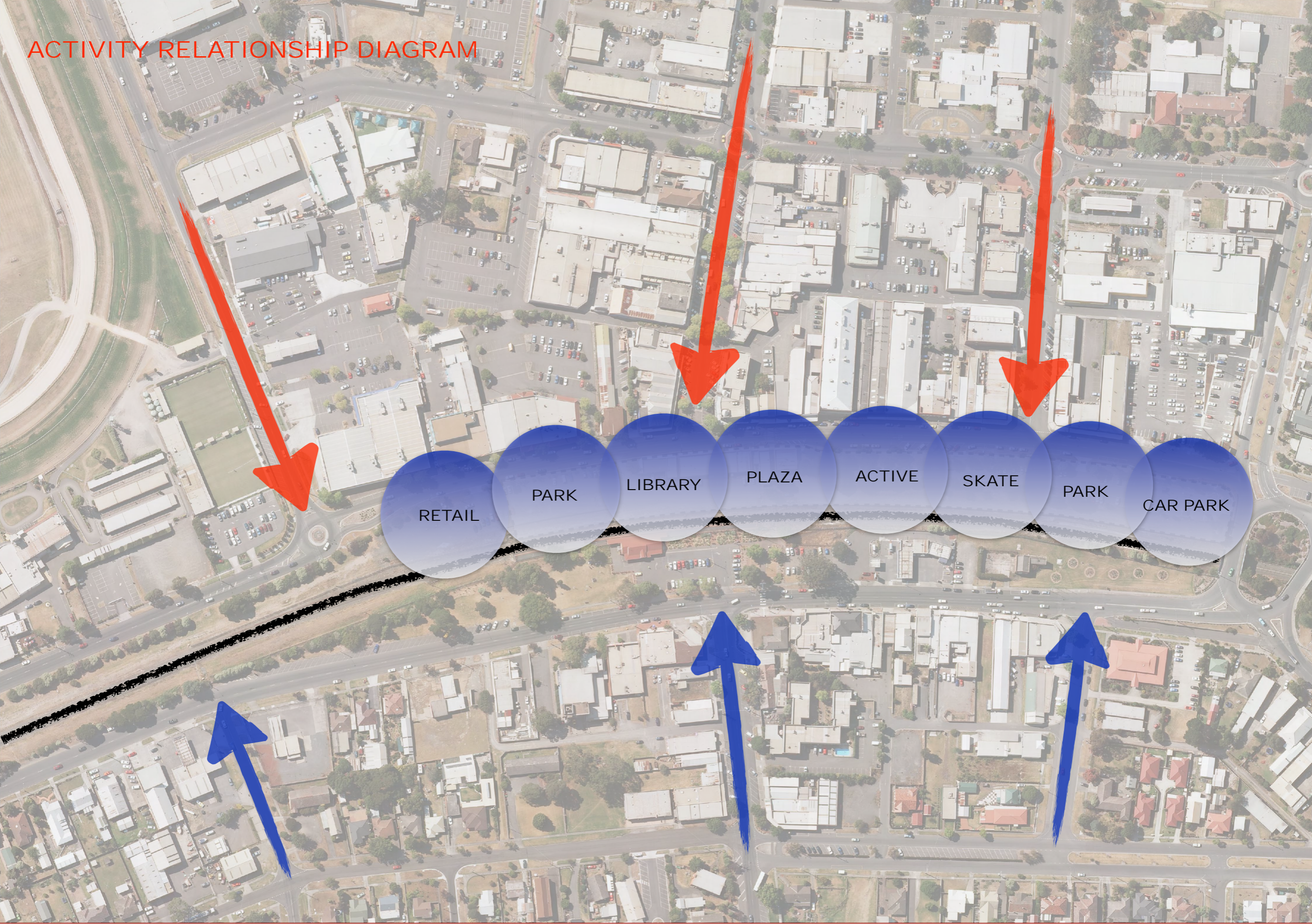

COMMUNITY HUB BUILDING



VISUAL CONNECTIONS @ GROUND

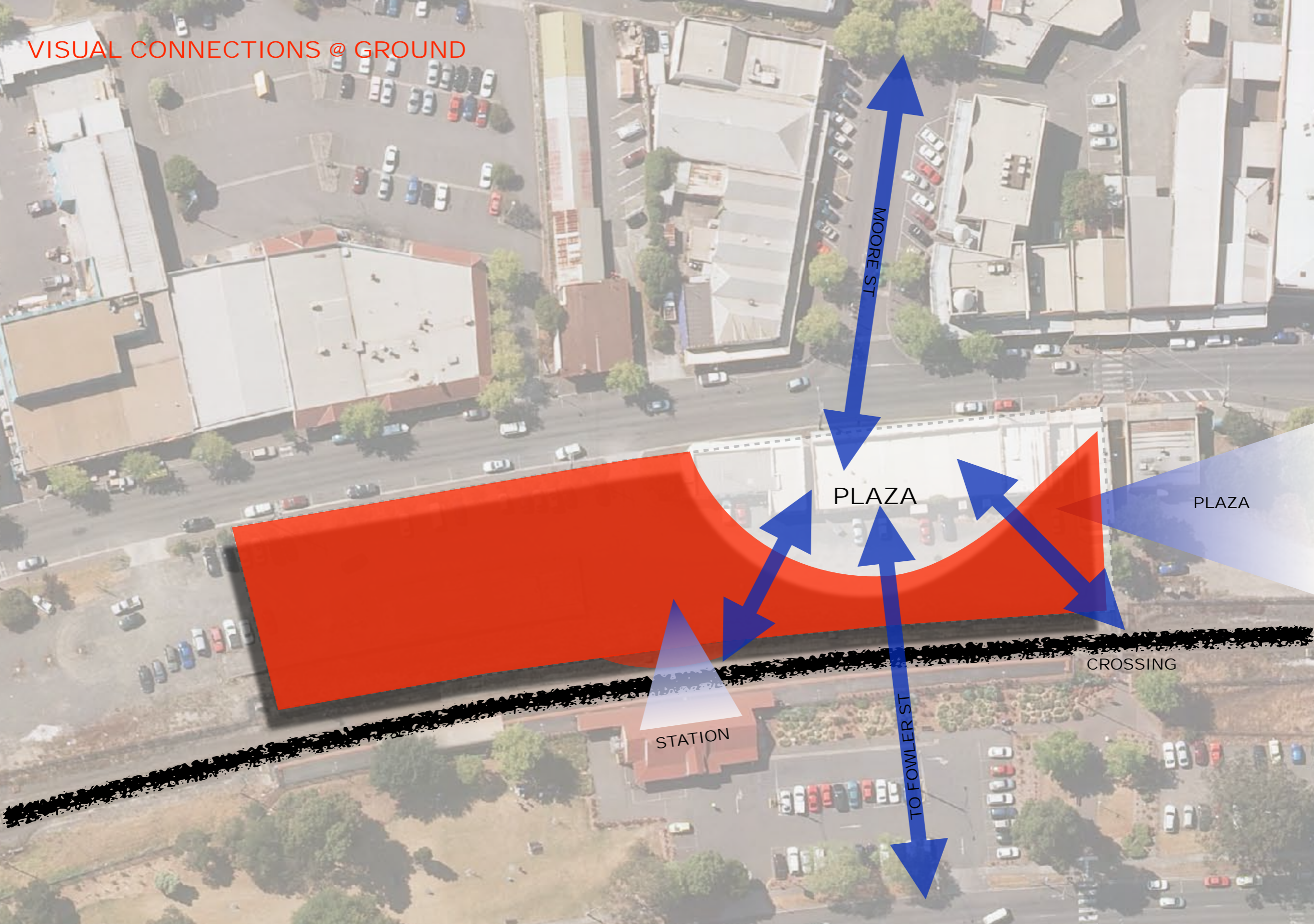

VISUAL CONNECTIONS @ LEVEL 1

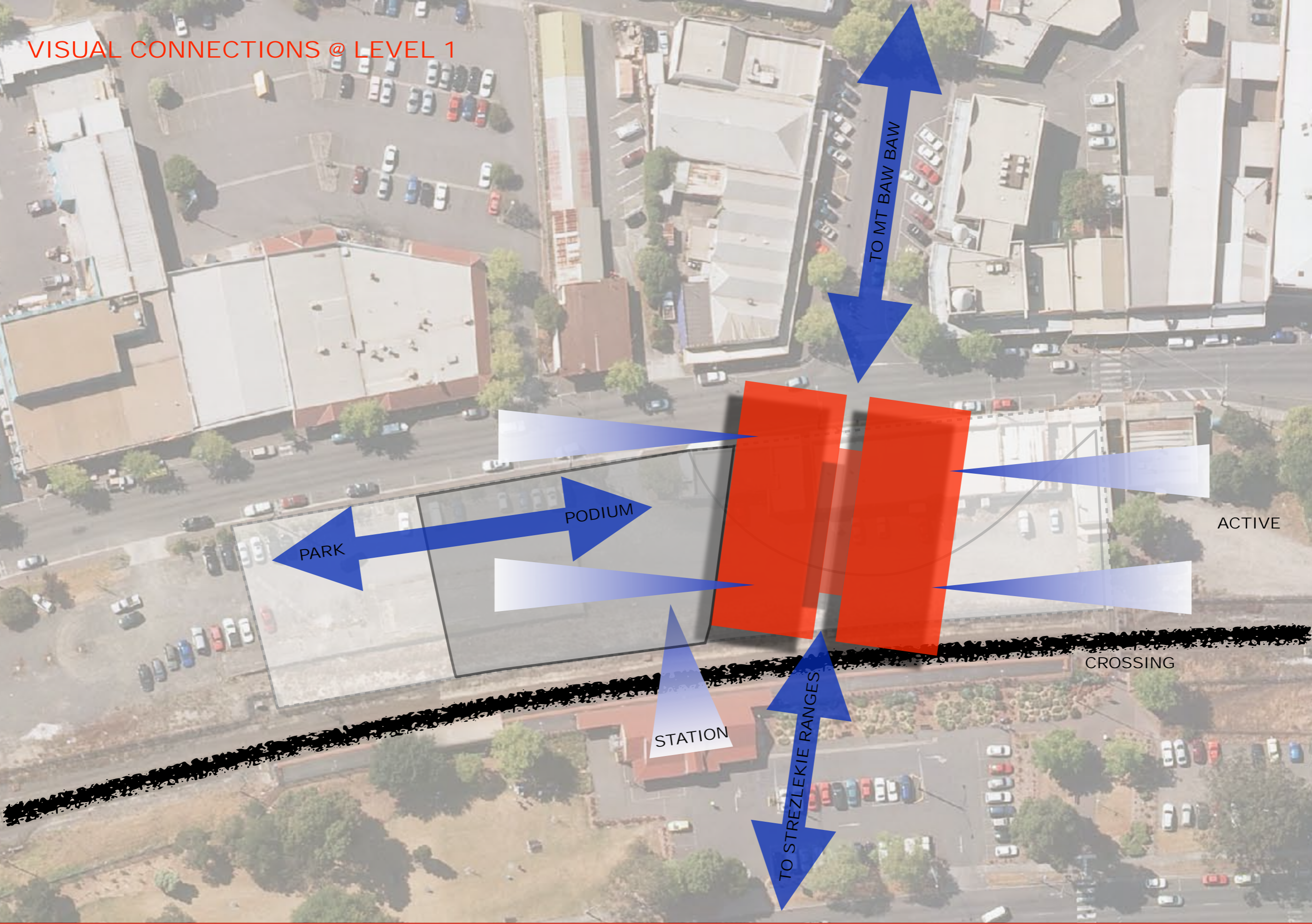

PROGRAM RELATIONSHIP @ GROUND

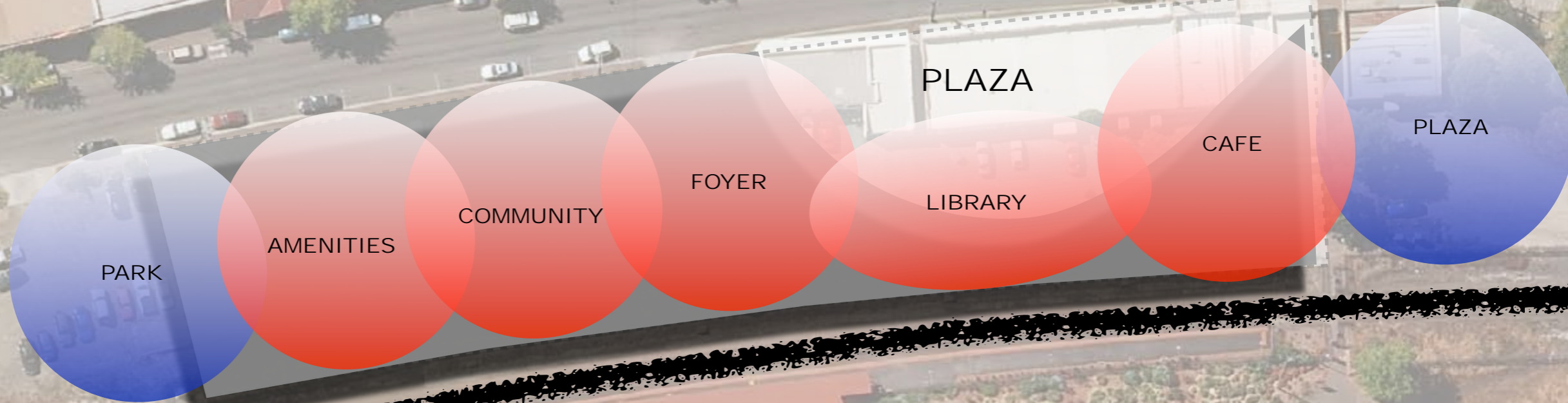

PROGRAM RELATIONSHIP @ LEVEL 1

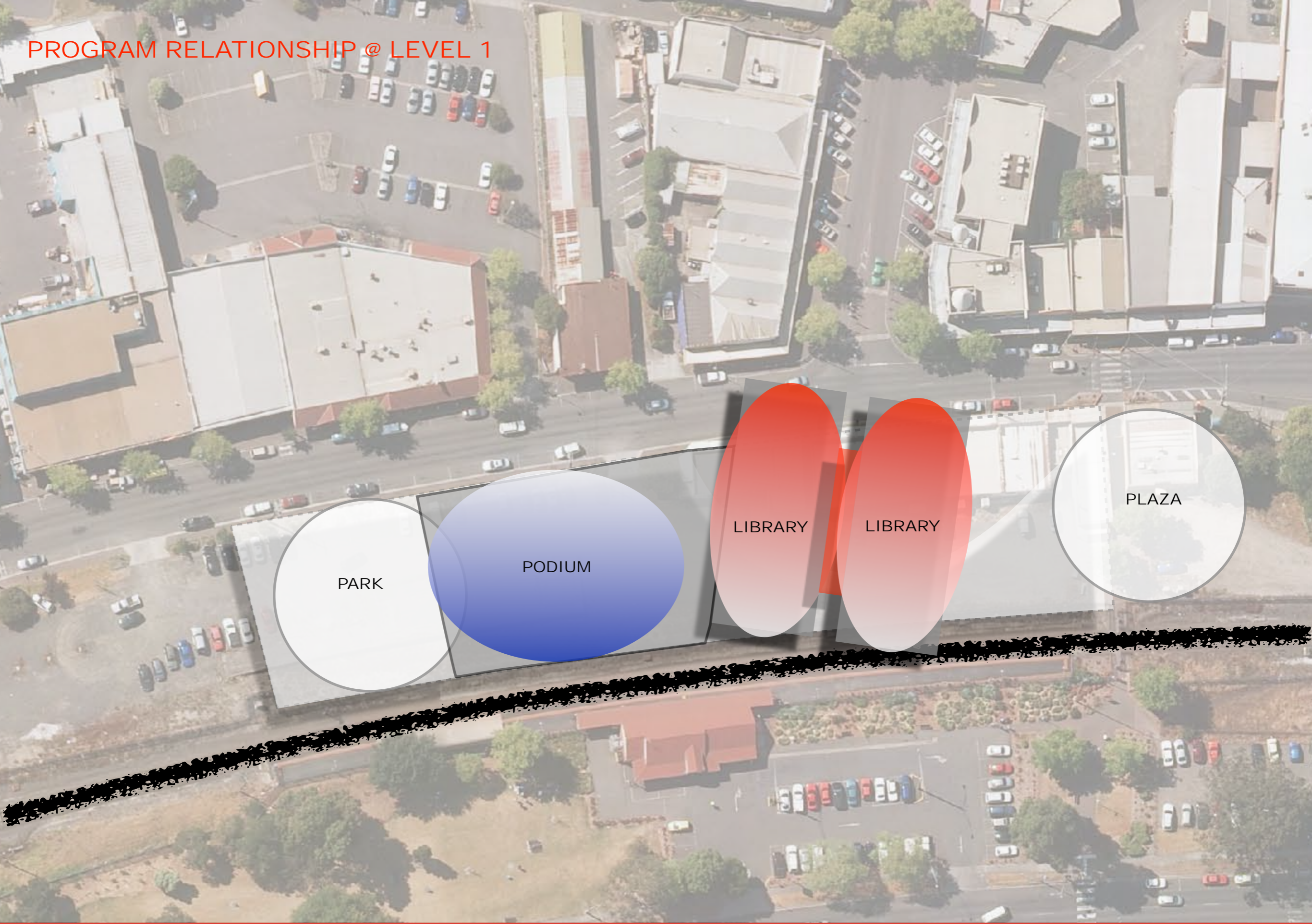

PARK

PODIUM

LIBRARY

LIBRARY

PLAZA

SITE PLAN

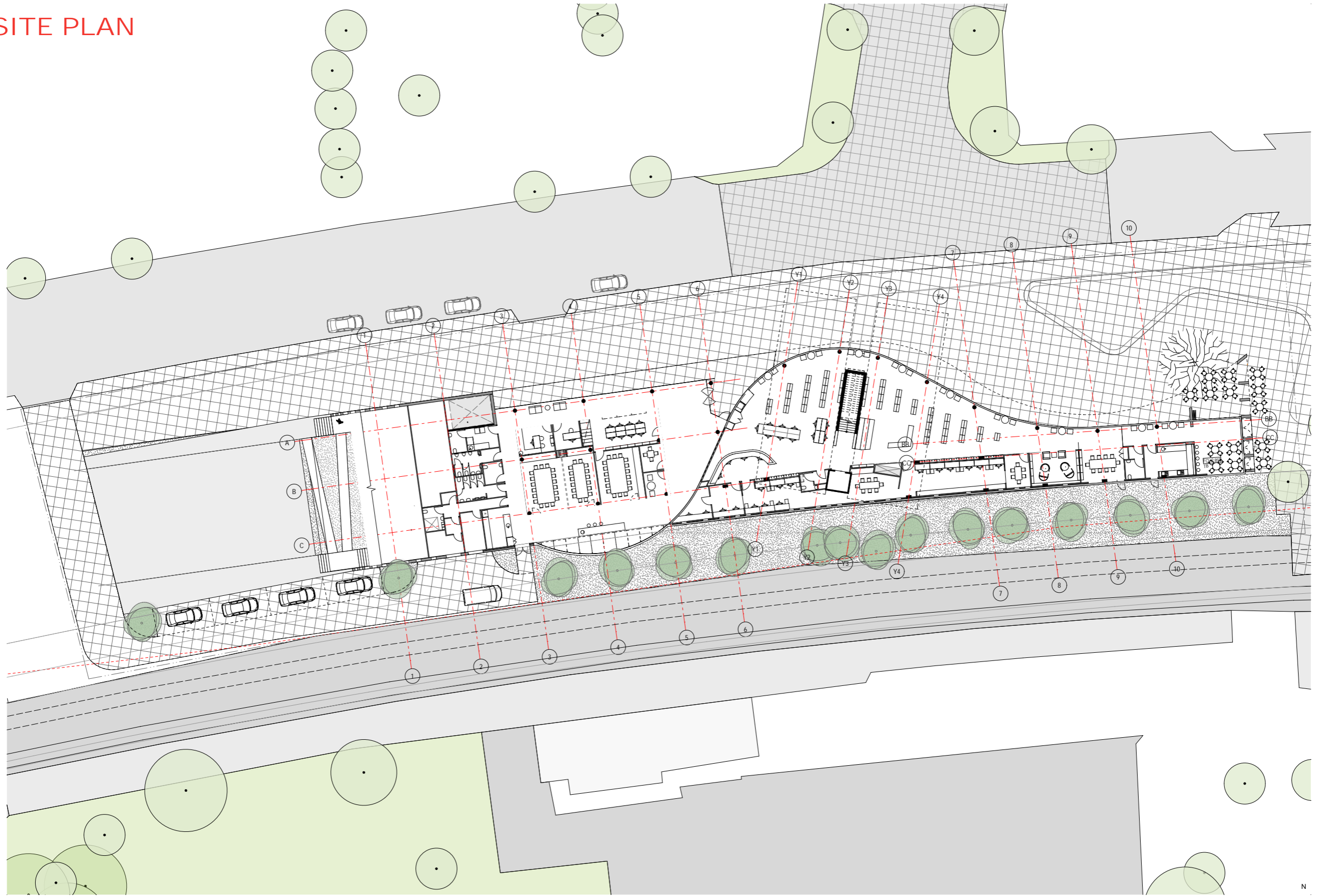

SITE PLAN

LaTrobe City Council - MOE RAILWAY PRECINCT

1:200 @ A1
 MARCH 2011
 SCHEMATIC DESIGN

ESD

Passive Design

- Minimisation of active energy consumption and CO₂ emissions through
 - Building orientation, thermal mass and high insulation levels
 - External shading and high performance glazing
 - Night purge and wider temperature control bands
 - Green roof – improves local environment, thermal insulation
- Optimisation of natural daylight and external views.

Internal Environmental Quality

- Improved ventilation rates;
- Reduced VOC's through appropriate material selection; and
- Reduced glare through shading and appropriate lighting design



Energy

- Encourage the purchase of Green Power from electrical supplier;
- Onsite generation of electricity through photovoltaic cells
- High efficiency light fittings and digital lighting controls;
- Displacement type mechanical airconditioning system; and
- Use of solar hot water generation.

Water

- Rainwater harvesting for flushing and irrigation; and
- High efficiency water fixtures and fittings.



SERVICE STRATEGY

© FRANCIS JONES MOREHEN THORP PTY LTD 2011 ABR 28 101 197 219

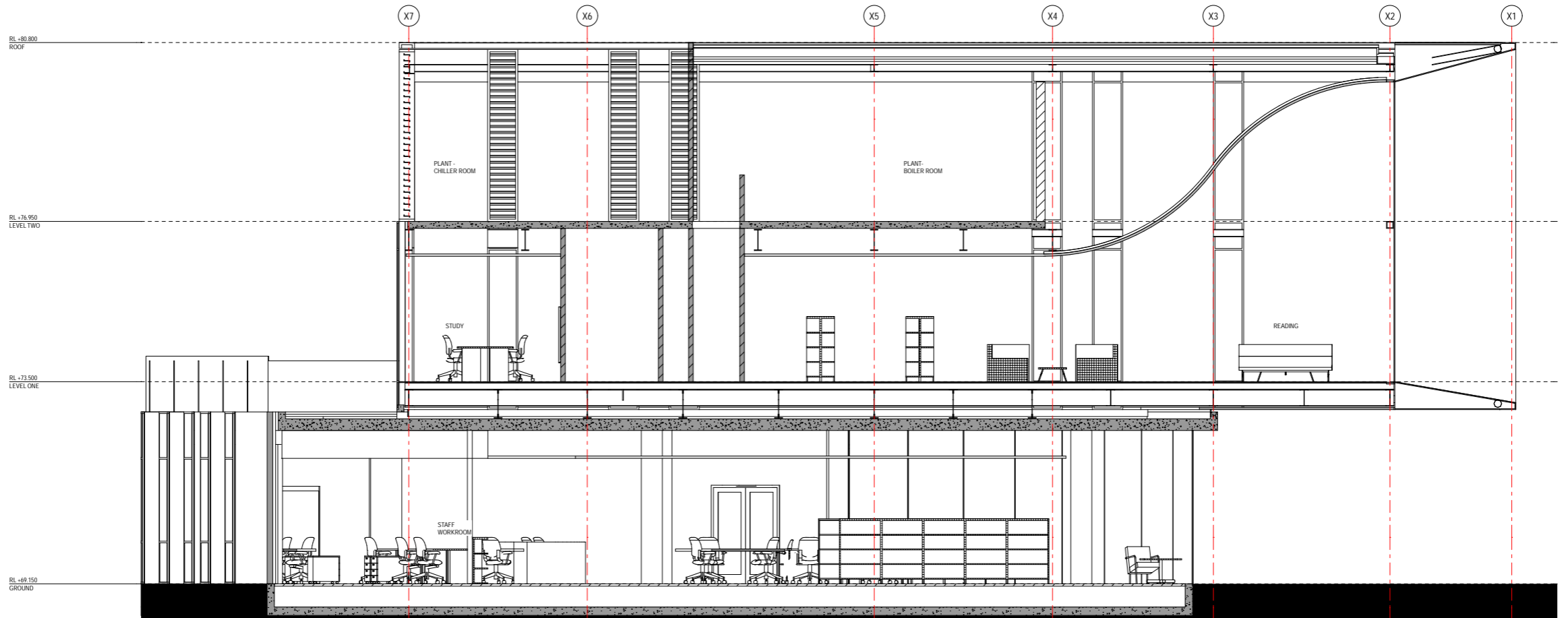

1 SECTION GENERAL COLLECTION

Materials

- Use of materials from sustainable sources;
- Source local materials;
- Use of recycled materials;
- Use of low VOC materials; and
- Reduce PVC usage.

Transport

- Optimise bicycle usage for staff and visitors; and
- Encourage use of public transport and car pooling.

