

## MOE YOUTH PRECINCT

TCL + Oasis Skate Park Design

Developed Design Presentation

July 2012

---

## MOE RAIL PRECINCT REVITALISATION YOUTH PRECINCT

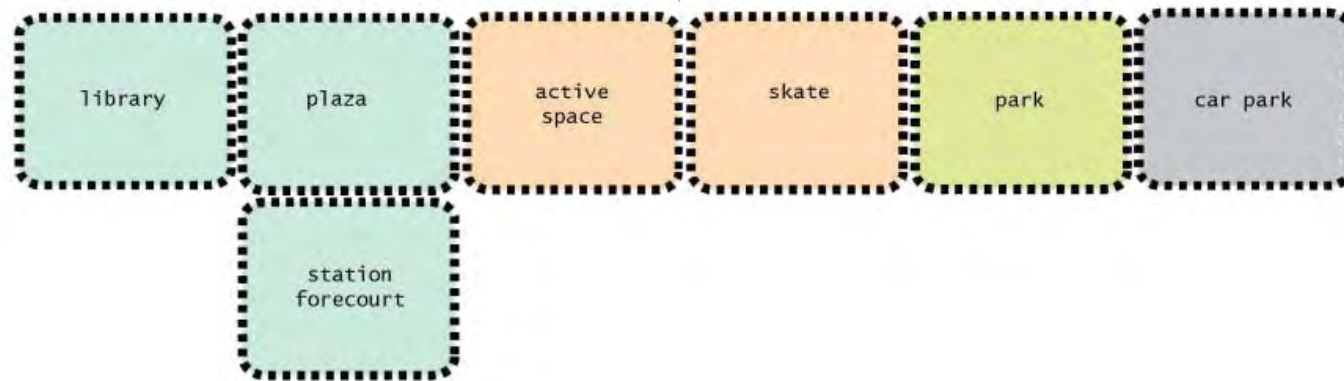

Moe Rail Revitalisation Initial Response

- Integrating Space and Functions

## MOE RAIL PRECINCT REVITALISATION YOUTH PRECINCT

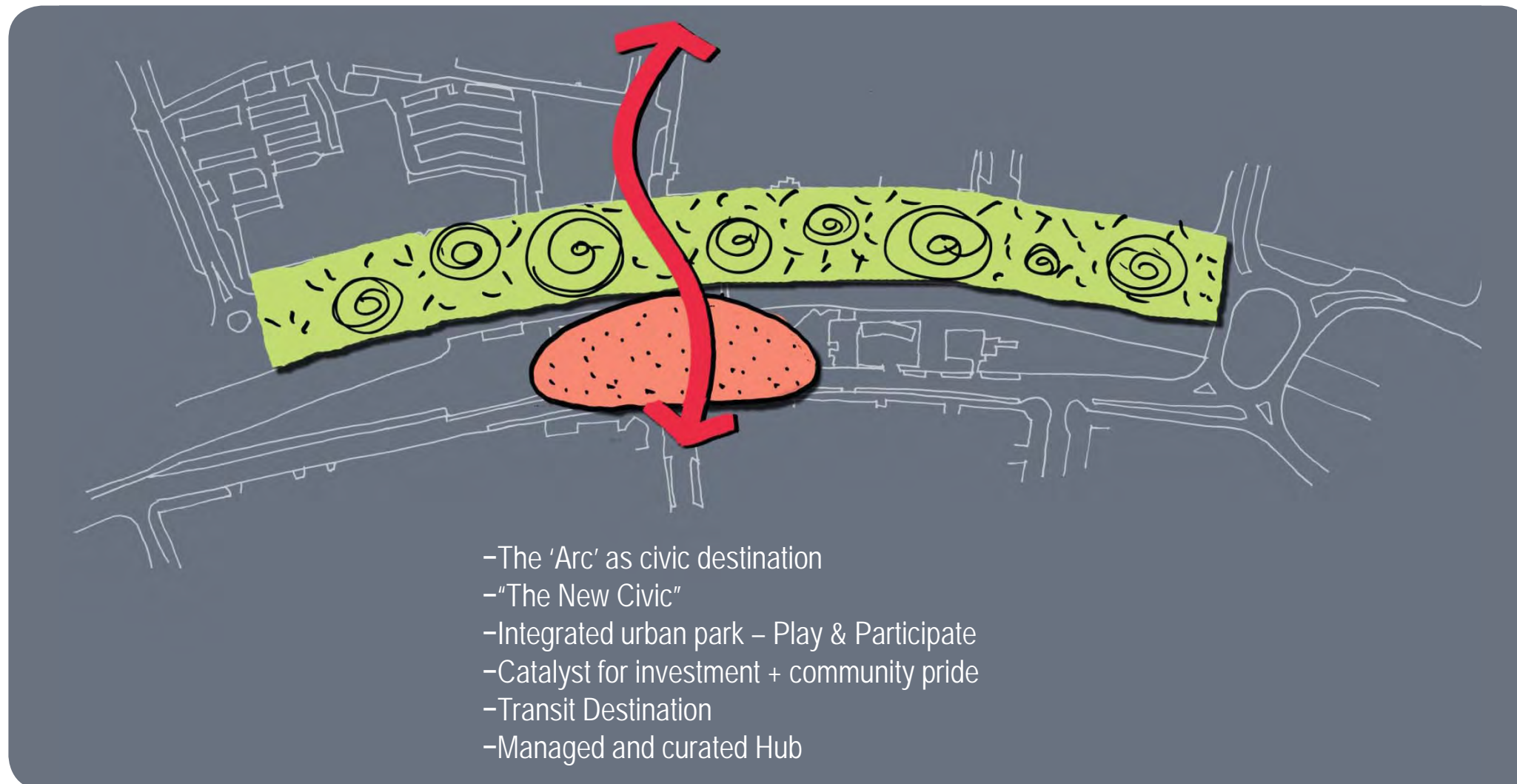

## Moe Rail Revitalisation Initial Response

- Overall Urban Design Principles

# MOE RAIL PRECINCT REVITALISATION YOUTH PRECINCT

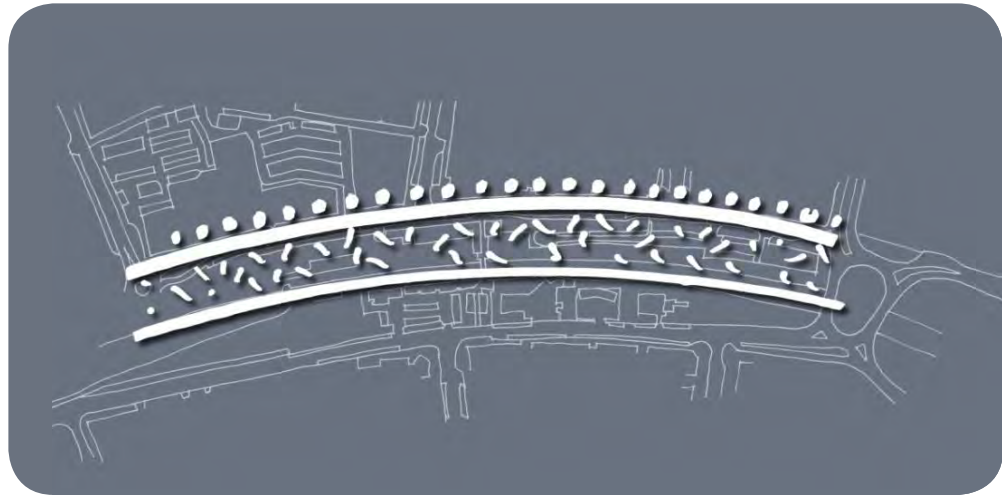

Overall Urban Design Principles

- The Arc as a Civic Destination
- The 'New Civic'
- Integrated Urban Park: Learn, Play, Participate
- A Managed and Curated Hub
- A Catalyst for Investment + Community Pride
- A Transit Destination

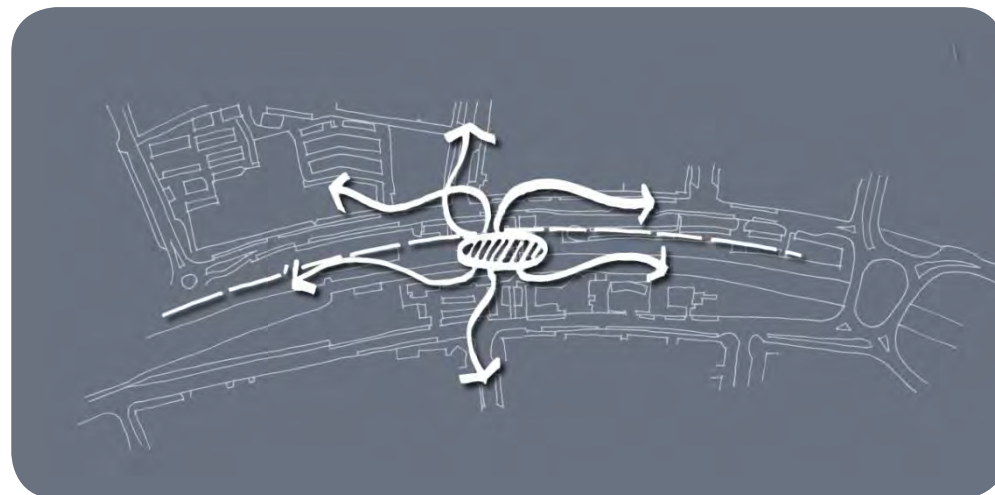
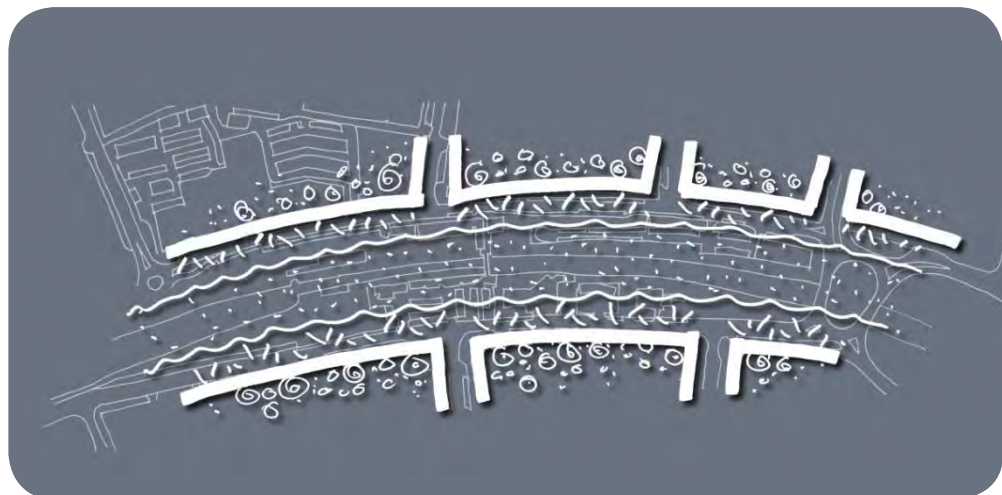
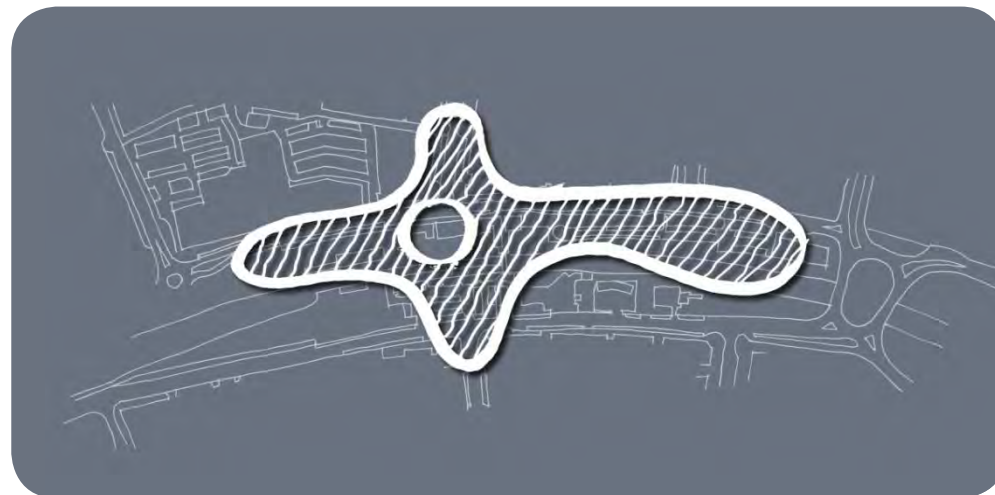
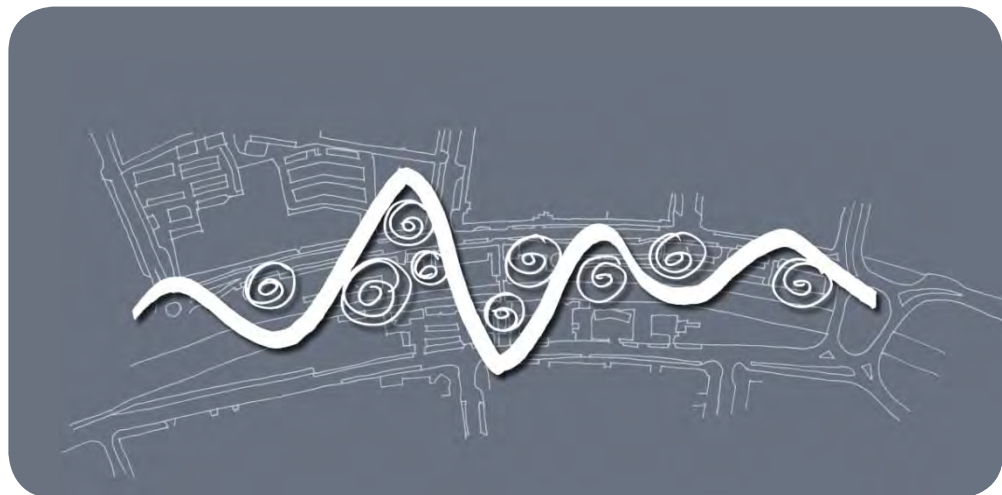

MOE RAIL PRECINCT REVITALISATION YOUTH PRECINCT

## Overall Urban Design Principles

- Linking Activities
- Creating a vibrant civic space

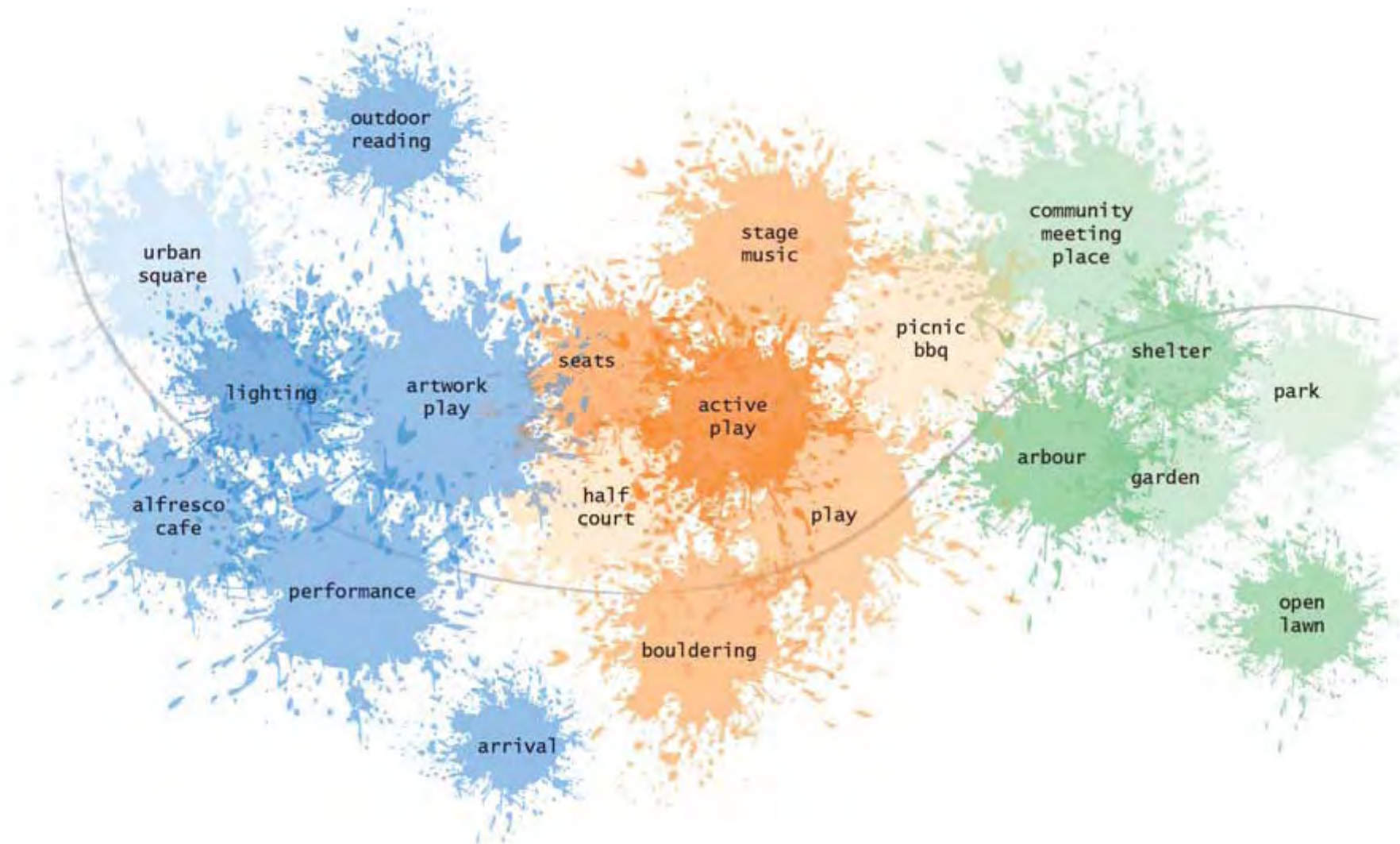

# MOE RAIL PRECINCT REVITALISATION YOUTH PRECINCT



Concept Design Overview:

- Multi- levelled space
- Multi- function space
- Extended functional hours
- Inclusive design for different activities

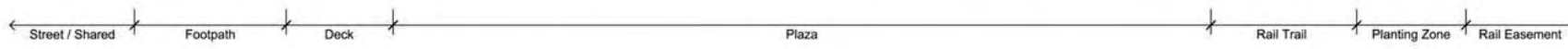
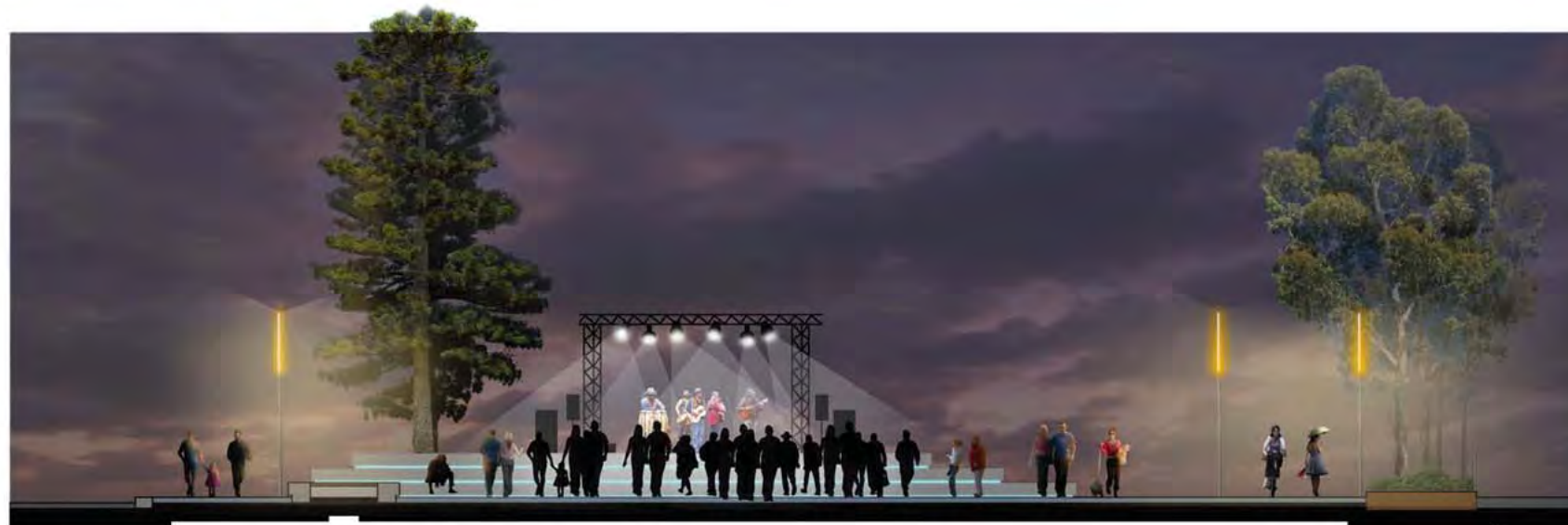

MOE RAIL PRECINCT REVITALISATION YOUTH PRECINCT

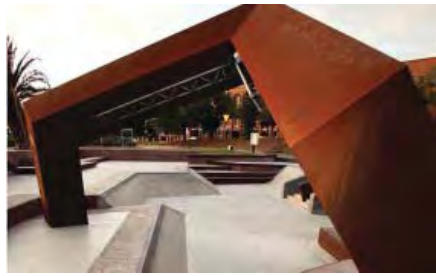

Geelong Youth Activities Area Grant Design

## Play

Venice Beach Skate Park Grant Design Group



MOE RAIL PRECINCT REVITALISATION YOUTH PRECINCT



## Play



MOE RAIL PRECINCT REVITALISATION YOUTH PRECINCT



### Community Consultation Outcomes

- Skateboarding, BMX biking, and Scooters
- Varied features for different levels of skill
- Basketball, Soccer, Football, and Recreational Cycling
- Open Spaces for passive recreation
- Moonlight Cinema
- WiFi and music
- Safer transit options to the Youth Precinct
- 'Favourite Spaces' included Geelong Waterfront, Federation Square, Rampfest, Newborough BMX Track, Docklands



## Perform



MOE RAIL PRECINCT REVITALISATION YOUTH PRECINCT



## Relax



MOE RAIL PRECINCT REVITALISATION YOUTH PRECINCT



# MOE RAIL PRECINCT REVITALISATION YOUTH PRECINCT

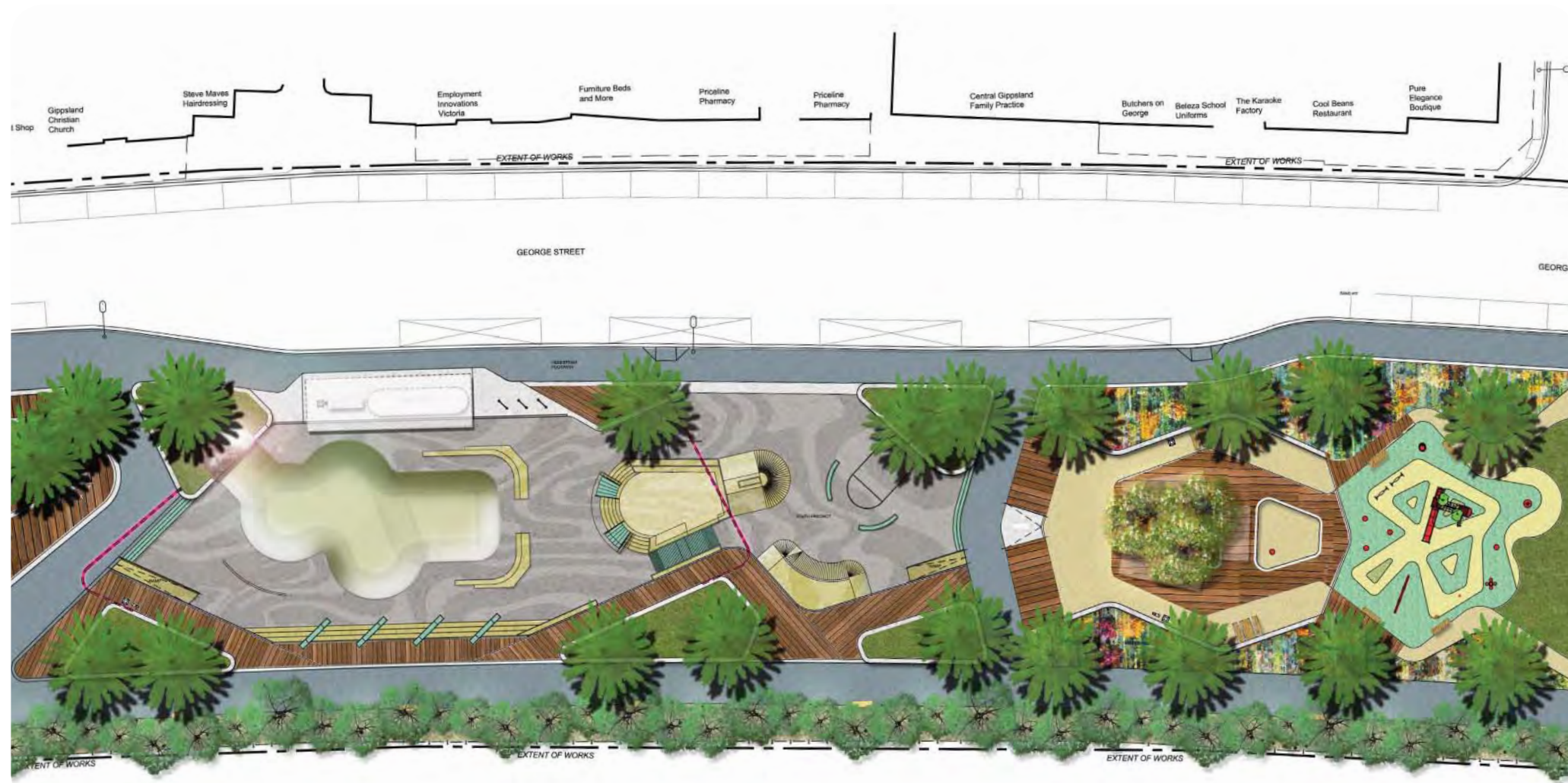

## Youth Precinct Design Response

- Placing Moe's youth at the heart of the site
- Creating a vibrant and diverse space
- Providing numerous choices for all age groups
- Including more sports - football and cricket
- Creating a safe and legible connection between spaces and activities
- Locating BBQ and Picnic facilities centrally to play options
- Increasing pedestrian and visual connection through the site

# MOE RAIL PRECINCT REVITALISATION YOUTH PRECINCT



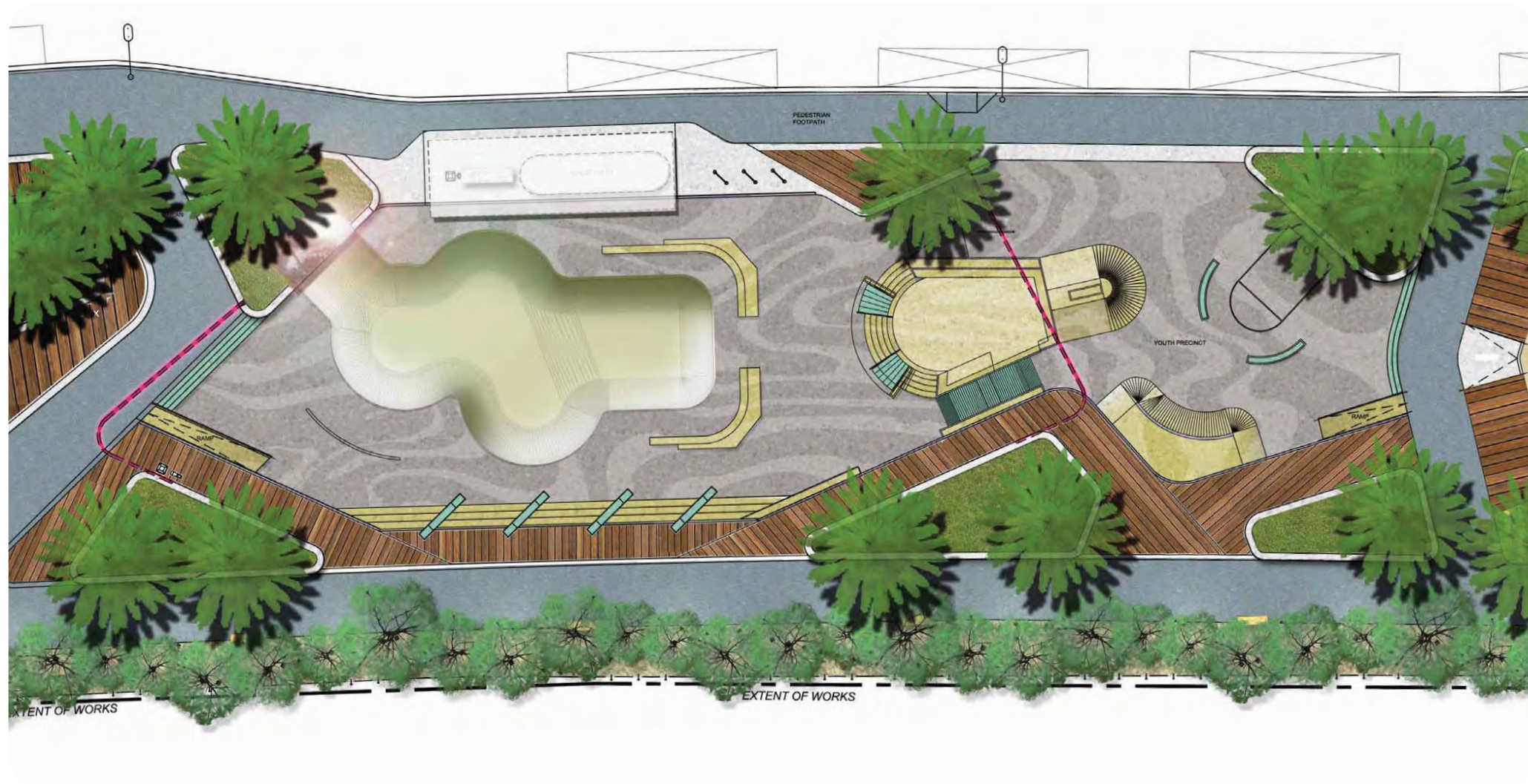

## Youth Precinct Design Response

- Multi-functional skate/bike elements
- Material variation to increase legibility of elements

# MOE RAIL PRECINCT REVITALISATION YOUTH PRECINCT

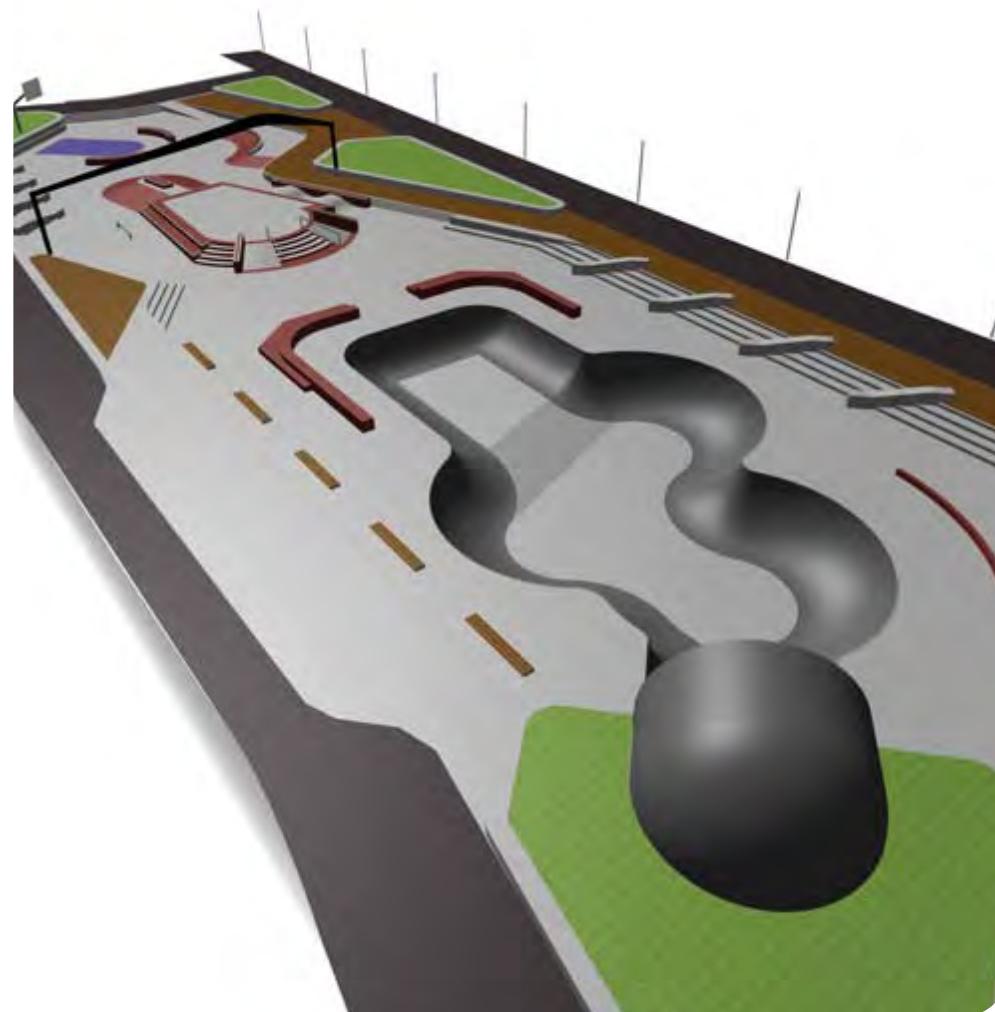
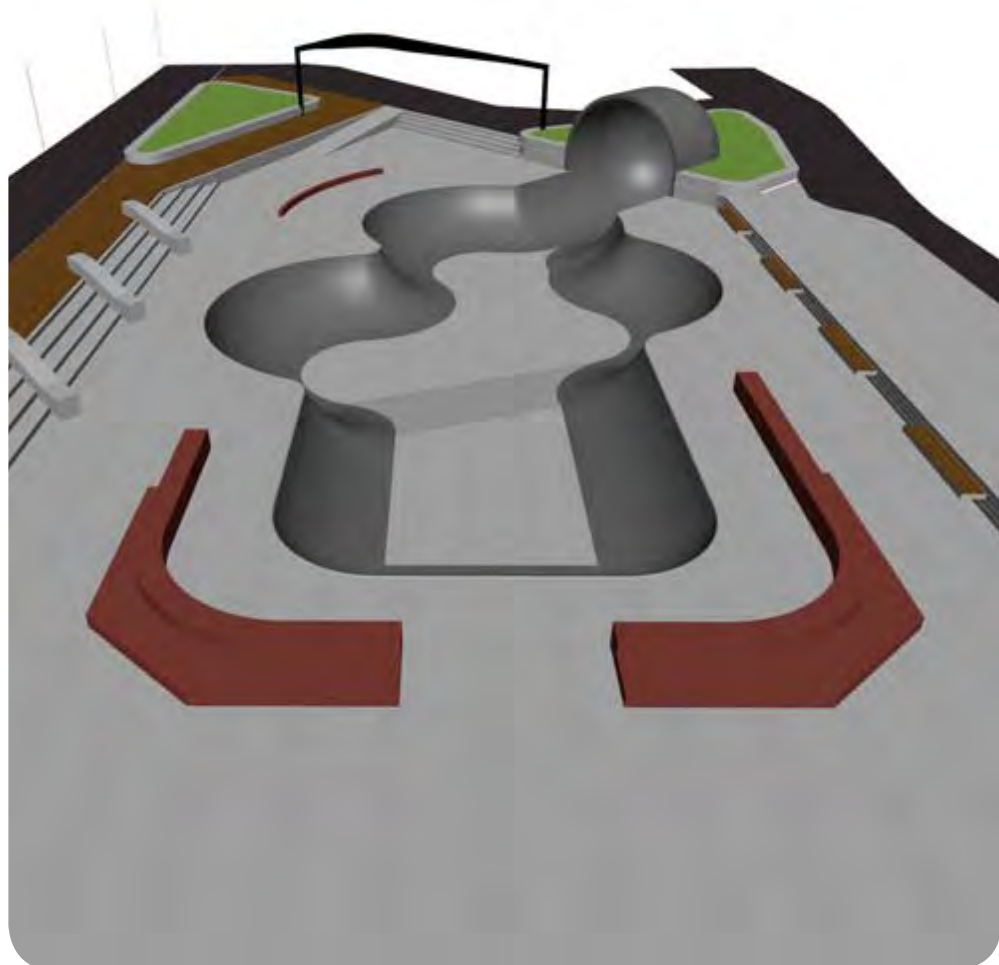

### Youth Precinct Design Response

- Multi-functional skate/bike elements
- Material variation to increase legibility of elements
- Integration of LED lights to promote safety at night
- Clear sight lines maintained to the site context
- Lowered level to promote safe transition between Youth Precinct and surrounding activities

## MOE RAIL PRECINCT REVITALISATION YOUTH PRECINCT



### Youth Precinct Design Response

- Central elements encourage sharing of play areas
- Proposed frame structure incorporates music, lighting, and future information displays

---

## MOE RAIL PRECINCT REVITALISATION YOUTH PRECINCT

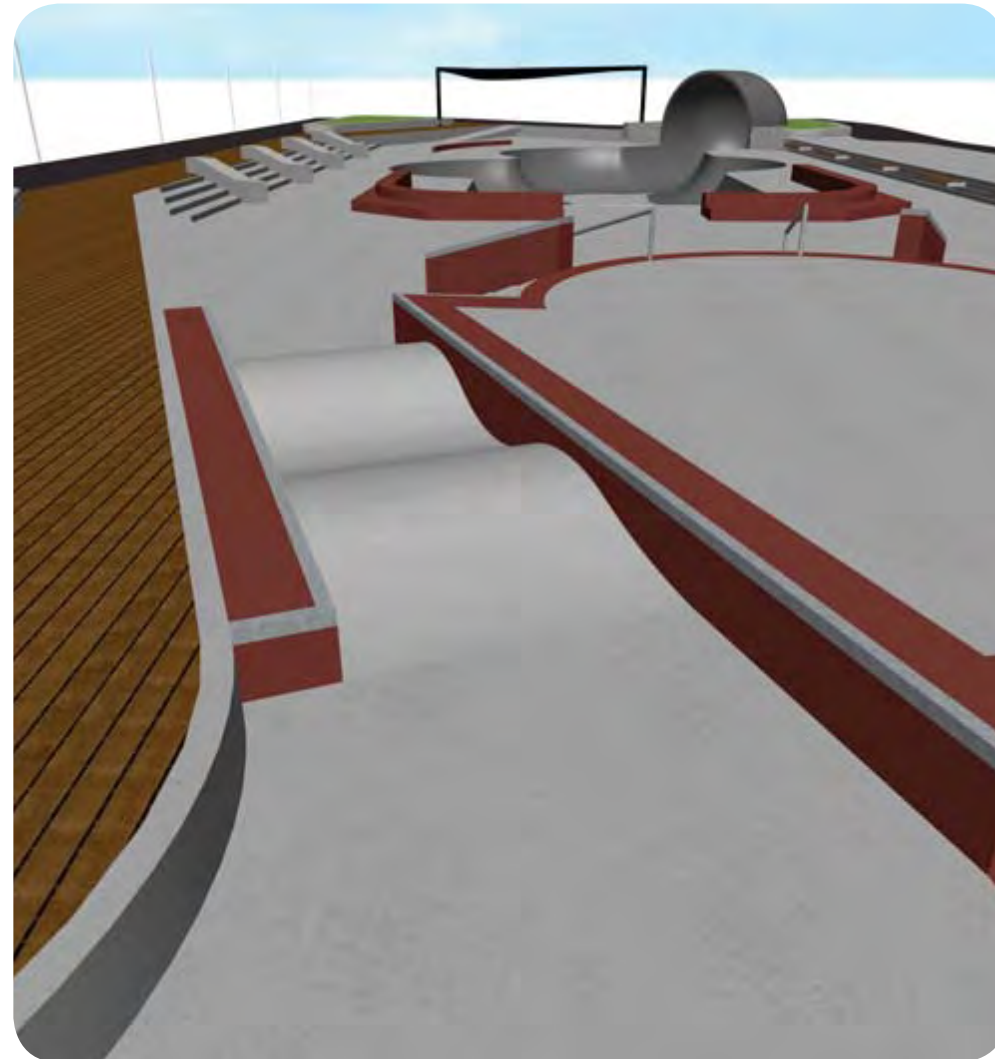
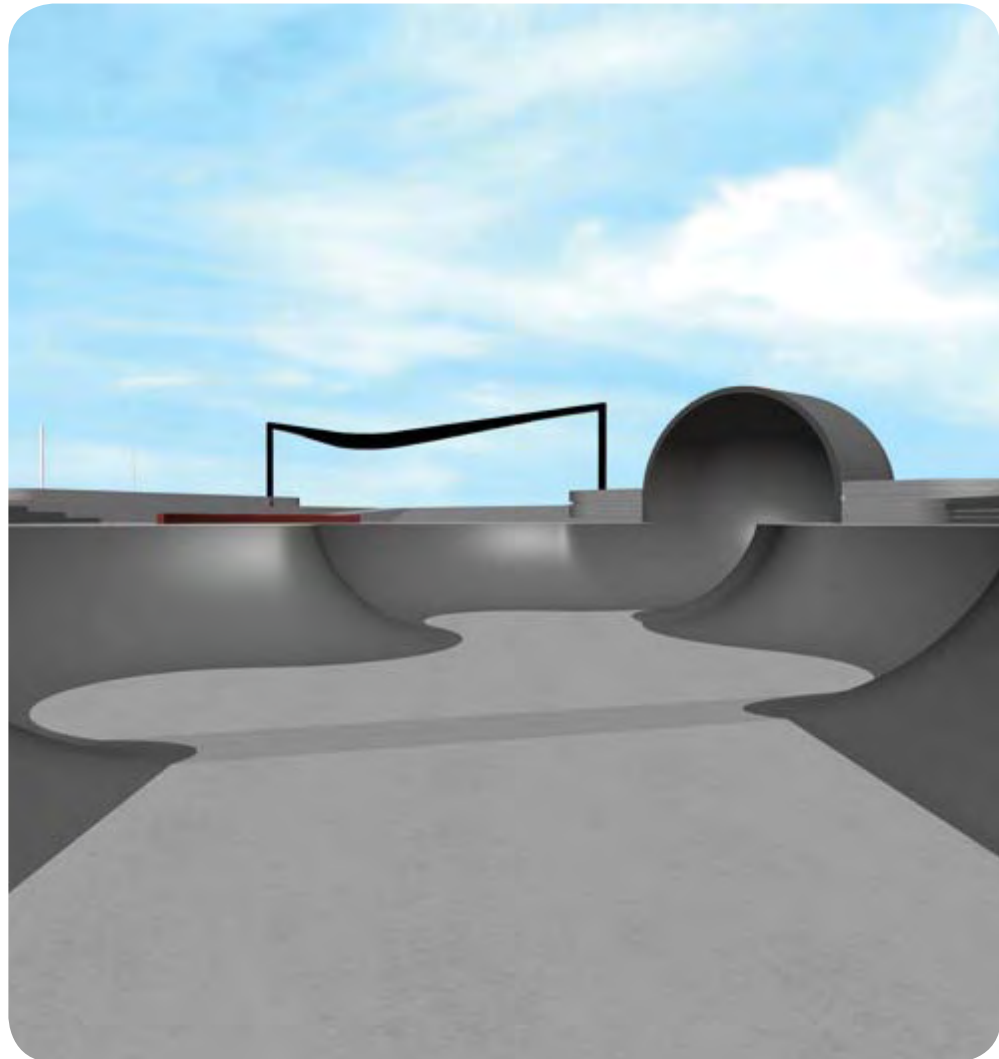

#### Youth Precinct Design Response

- Bowl framed by seating to encourage participation of other users in the precinct
- Feature elements such as “whooptys” differentiate the precinct from surrounding skate parks
- Continuous timber edge provides a seating edge for large youth-focused events

---

## MOE RAIL PRECINCT REVITALISATION YOUTH PRECINCT



Precedent Images



---

## MOE RAIL PRECINCT REVITALISATION YOUTH PRECINCT



Precedent Images



MOE RAIL PRECINCT REVITALISATION YOUTH PRECINCT



### Play and Picnic Area

- Central BBQ and seating space
- Visual connections to the Youth Precinct and Children's play
- Play equipment for young children
- Tactile and warm material palette
- Transition to the 'Village Green'

## MOE RAIL PRECINCT REVITALISATION YOUTH PRECINCT



Precedent Images



MOE RAIL PRECINCT REVITALISATION YOUTH PRECINCT



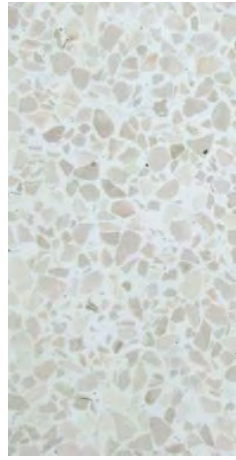

In situ Concrete  
*Coloured and exposed aggregate finishes*



Timber Decking  
*Picnic and Play Areas*



Bitumen  
*Pedestrian Paving*



Gravel  
*Park Pedestrian Path*



Lawn  
*Oval Area*



'Rubaroc'  
*Recycled Rubber Softfall Surface. UV Stable colours to be confirmed*



P.C. Finish  
*Play Equipment & Features*

Youth Precinct & Play Palettes

MOE RAIL PRECINCT REVITALISATION YOUTH PRECINCT